

Published:
Jun 16 2018 - 23:00



With just one week until we kick off with our first block pattern, it's time to share the fabric requirements.

INGREDIENTS

22 Fat Quarters *OR* 2 Layer Cakes
4 ½ yards background
1 yard border
5/8 yard binding
4 ½ yards backing

GARNISHES

template plastic*
hand or machine applique supplies*

**these garnishes are optional and will only be used if you choose to follow the paths with applique blocks*

Some notes about the design:

- This quilt is designed to work with precuts - fat quarters or Layer Cakes® are the best choice. Working with fat quarters or Layer Cakes® will result in a delightfully scrappy quilt.
- If scrappy is not your thing or you just want to have more repetition of prints or colors, you may decide to substitute a few of the fat quarters for a half yard or two of a favorite fabric.
- The quilt is a medallion design meaning that we start with a center block and work our way out with a series of borders around the center - sort of like a giant log cabin!
- Medallion quilts require a certain level of accuracy so before you start sewing, it's a good idea to practice and measure your scant 1/4" seam.
- Even though the blocks themselves will be a surprise each week, you don't need to worry too much about color placement with a medallion design as the rounds each week let you balance things out a little easier than a standard horizontal sampler quilt.

We want you to have FUN with this quilt along! We have a wonderful team of Chefs who have worked very hard to design this experience and they are all around to answer questions throughout this process. Don't forget to visit their sites and follow them to see what fabrics they're working with and get some sneak peeks into the process.

moda BAKE SHOP



EASY

Hi all! This is Camp Counselor Mona Phelps here from [Kentucky Whittaker Creations](#). I hope that you've enjoyed your time at Camp Oda May so far!

NOTE: This is one post in a series of quilt-along posts. Start from the beginning with the first post [{here}](#).



I am loving the "Choose your own adventure" trip that we're taking and seeing everyone's progress in the [Moda Bake Shop Bakers Facebook group](#) and on Instagram with [#chooseyourownadventuregal](#). We've been to [Dresden Peak](#) and visited [Star Valley](#). Now it's time to travel to a new area of Camp Oda May. Join me as we venture up Path A to Four Points - make sure you pack your water bottles and trail mix!

Individual blocks finish at 3" (unfinished 3 1/2").

Please **READ** all instructions before you begin cutting and sewing.

INGREDIENTS

- 2 fat quarters OR 6 layer cakes

Special notes:

Fabric choices: you will need two complementary colorways. If you are using fat quarters, choose 2 different colorways. If you are using layer cakes, it can be difficult to have 3 layer cake pieces that are identical; therefore, you can choose 3 of one colorway (Color A) and 3 of another (Color B). For example, you can see that I chose 3 gray and 3 peach. While the fabric patterns aren't identical, they are in the same color family. (You are also free to go completely scrappy on this round!)

7/2/2018

Original Recipe can be found at www.modabakeshop.com

Recipes are sometimes altered to correct errors. Please ensure that you have downloaded the most recent Printer Friendly Version before starting your project. If you find a mistake in this pattern, please contact modabakeshop@unitednotions.com.

This is an original pattern not intended for sale.

Cornerstones: Later this week you will find out about cornerstone options (quilt blocks that “anchor” a particular border). If you choose to NOT use cornerstones, you will need 32 finished Four Points blocks. If you decide you want to include cornerstones, you will only need 28 finished Four Points blocks. The fabric requirements and directions are for all 32 blocks.

INSTRUCTIONS

Before beginning:

- Read through the entire instructions
- Seams are all scant 1/4"
- Width of Fabric is abbreviated as WOF and is assumed to be 42".
- Right sides together is abbreviated as RST

The Four Points block is a traditional four patch block. There are many ways that you can assemble these blocks. One is cutting your fabric into individual 2" square pieces and assembling the block. However, I am going to share with you a strip piecing method.

Cutting Instructions

- From Layer cakes: cut (13) 2" strips for both Color A and Color B (a total of (26) 2" x 10" strips)
- From Fat Quarters: on the long side of the fabric (22" length), cut 6 2" strips of Color A and Color B (a total of 12 2" x 22" strips)

Assembling the Block

FOUR PATCHES

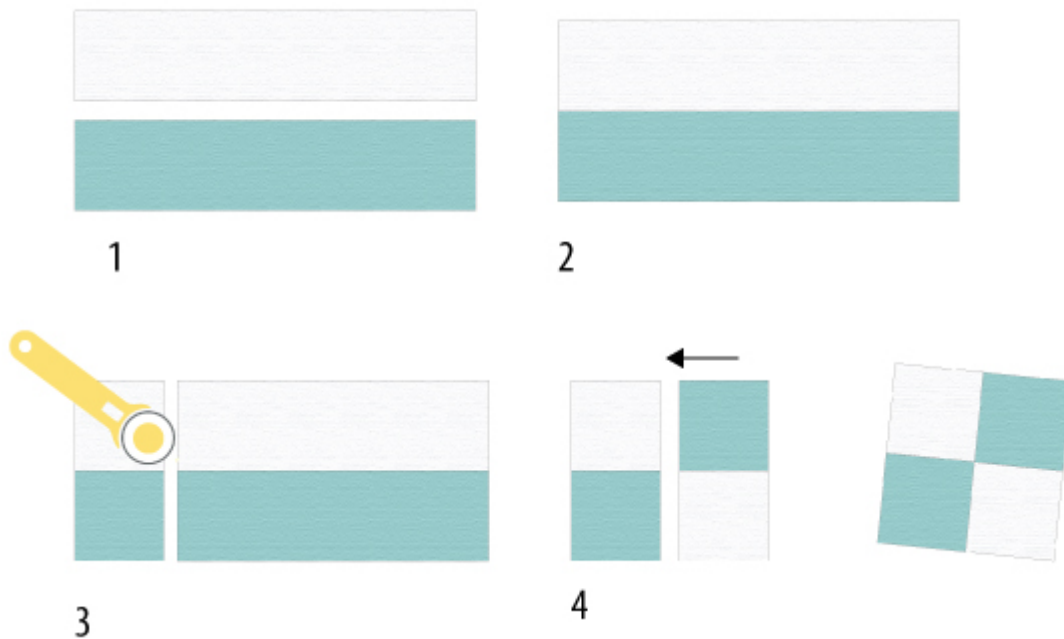

1. Pair a strip of Color A with Color B right sides together
2. Sew on the long side with a scant 1/4" seam.
3. Trim strip units into 2" segments.
4. Sew together (2) 2" segments, flipping one so the light and dark fabrics are opposite.

Chain piecing makes this process fast!

Press and trim to 3½" square. Repeat to make the number of required blocks.

Assemble in rows to attach to the center of your quilt. You will make 2 rows of 7 blocks each and 2 rows of 9 blocks each.

7/2/2018

Original Recipe can be found at www.modabakeshop.com

Recipes are sometimes altered to correct errors. Please ensure that you have downloaded the most recent Printer Friendly Version before starting your project. If you find a mistake in this pattern, please contact modabakeshop@unitednotions.com.

This is an original pattern not intended for sale.

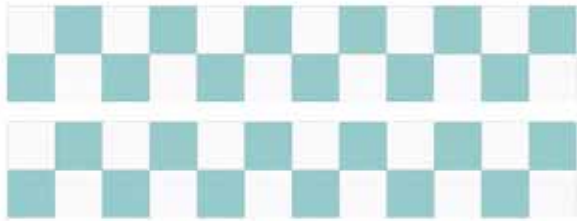
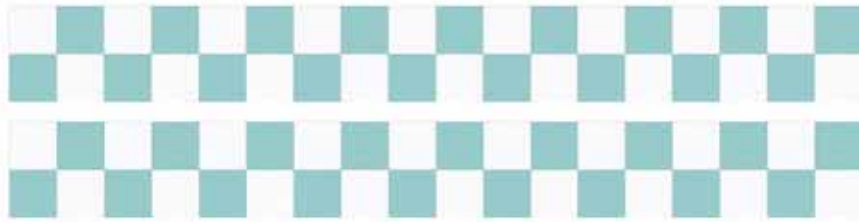

Attach the shorter rows to the right and left sides of your center block. Then, attach the longer rows to the top and bottom of your center block.

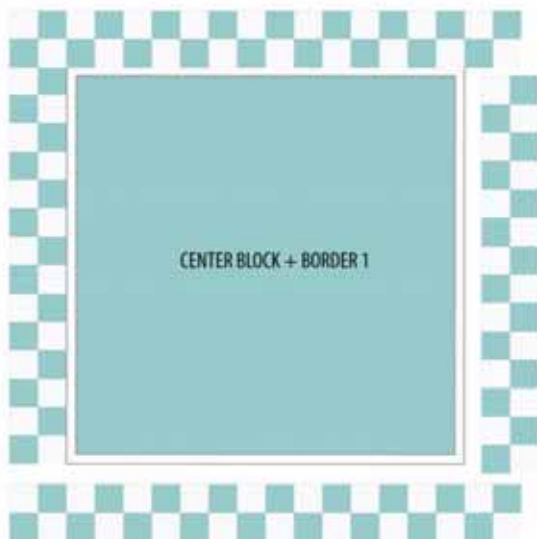

If you are using cornerstones, you will make 4 rows of 7 blocks each. Attach 1 row to the left and right sides of your quilt. (You will need to wait until Friday to get the details on the cornerstones and complete assembly).

CORNERSTONES OPTION

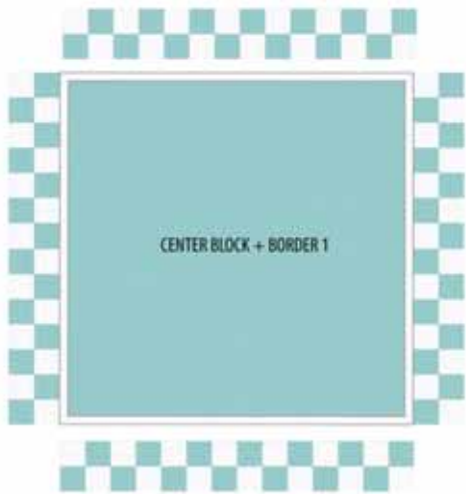

After this, your block should be 27 ½" square. If it's a little larger, you should square it up now. If it's a little smaller, you can add little fabric to your next border.

Don't forget - Path B will be available on Wednesday and you may decide you prefer that campground.

Thank you for joining me on this trip to Four Points. I hope that you're enjoying camp.

YIELD



Mona Phelps

[blog: [Kentucky Whittaker Creations](#)]

[instagram: [@mona.phelps](#)]

[facebook: [facebook.com/ky.whittaker.creations](#)]

7/2/2018

Original Recipe can be found at www.modabakeshop.com

Recipes are sometimes altered to correct errors. Please ensure that you have downloaded the most recent Printer Friendly Version before starting your project. If you find a mistake in this pattern, please contact modabakeshop@unitednotions.com.

This is an original pattern not intended for sale.

moda BAKE SHOP



Welcome campers! I'm camp counselor Kristin Esser from [Simple Handmade Everyday](#) here to guide you to Goose Grove. I hope you are all enjoying your time at camp--we've been so busy there's been no time to be homesick! I've been having fun jumping back and forth between Path A and B--and seeing all the amazing unique quilts popping up in the [Moda Bake Shop Bakers](#) Facebook group and on Instagram ([#chooseyourownadventureqal](#)). I packed snacks--so let's head on over to Goose Grove.

NOTE: This is one post in a series of quilt-along posts. Start from the beginning with the first post [here](#).

After this border, the quilt top finishes at 52.25" 52.25".

INGREDIENTS

- 2 fat quarters or 12 layer cake squares
- 7/8 yards background fabric

INSTRUCTIONS

Before beginning:

- Read through the entire instructions
- Right sides together is abbreviated as RST

The Goose Grove block is a traditional flying geese block. There are many ways that you can assemble these blocks. The method I am sharing today is the "stitch and flip", but feel free to use your favorite method. Over on my blog I've shared [5 Ways to Make a Flying Geese Block](#), if you are feeling adventurous. You need a total of 96 flying geese units for this border. If you choose the cornerstone version of this border, you will need 88 flying geese units.

This is quite a flock of flying geese! It's a great opportunity to go super scrappy or just alternate between a couple colorways, like I've done. Choose your own adventure!

Cutting Instructions

- From layer cakes or fat quarters: cut (96) 2.5" x 4.5" strips (If doing cornerstone option, cut 88 strips)
- From background fabric cut (192) 2.5" x 2.5" squares (If doing cornerstone option, cut 176 squares)

Assembling the Block

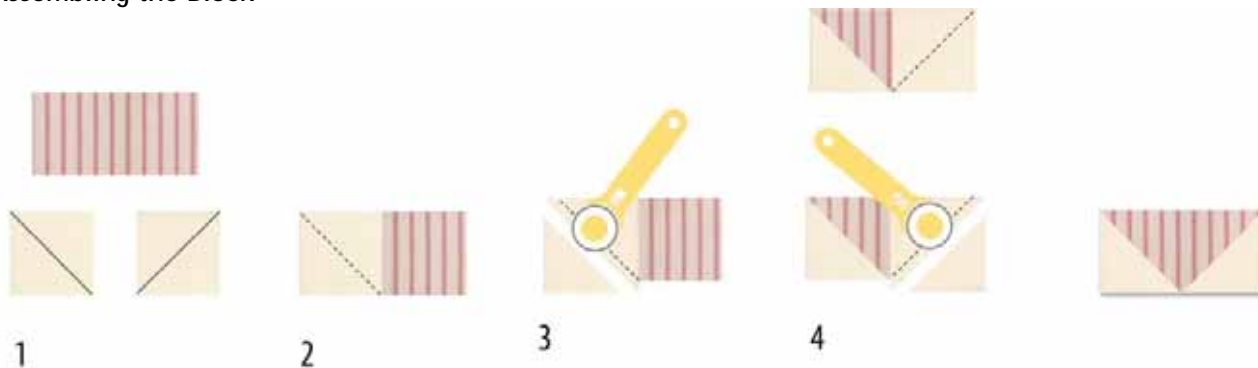

7/15/2018

Original Recipe can be found at www.modabakeshop.com

Recipes are sometimes altered to correct errors. Please ensure that you have downloaded the most recent Printer Friendly Version before starting your project. If you find a mistake in this pattern, please contact modabakeshop@unitednotions.com.

This is an original pattern not intended for sale.

1. Gather the (192) background 2.5" squares and draw a line diagonally corner-to-corner on the wrong side of the fabric. If you don't want to do all that marking, there are products available, like the [Clearly Perfect Angles cling](#), that allow you to skip the marking.
2. Place a background square on the left side of a 2.5" x 4.5" rectangle, right sides together, making sure that the diagonal line travels from the upper left to the bottom right corner of the square. Sew on the pencil line. (This is a perfect opportunity for chain piecing all 96 units.)
3. Trim the corner, leaving a 1/4" seam allowance as shown. Press unit open.
4. Repeat on opposite side.

Finished flying geese block measures 2.5" x 4.5". Repeat to create a total of 96 flying geese units.

Assembling the Round

We have shown the geese traveling in one direction around the quilt but you can vary the placement as you like!

Assemble blocks into rows as desired.

Without cornerstone:

- Sew 2 rows of 22 flying geese to attach to the sides
- Sew 2 rows of 26 flying geese to attach to top and bottom

With cornerstone:

- Sew 4 rows of 22 flying geese for all sides. The cornerstones will replace the 8 corners left blank as shown below.



Note: If you are having trouble getting your units to come out 2.5" x 4.5", you may consider making all the units bigger (2.75" x 4.75" strips and 2.75" squares), sew the block, and then trim to exactly 2.5" x 4.5".

YIELD

At this point your unfinished quilt should measure 52.25" x 52.25".

I hope you enjoyed your trip to Goose Grove, I had a ton of fun! Stay tuned for Path B, which will be available on Wednesday (and it's a good one!). Cornerstone option comes out on Friday!

Kristin Esser

[Blog: [Simple. Handmade. Everyday.](#)]

[Instagram: [@kristin_esser](#)]

[Facebook: [Simple. Handmade. Everyday.](#)]

7/15/2018

Original Recipe can be found at www.modabakeshop.com

Recipes are sometimes altered to correct errors. Please ensure that you have downloaded the most recent Printer Friendly Version before starting your project. If you find a mistake in this pattern, please contact modabakeshop@unitednotions.com.

This is an original pattern not intended for sale.



AMBITIOUS

Good morning from camp counselor Mary Andra Holmes. I'm at Orange Beach with campers whose creative adventure took them to Row 8 and we choose applique. The sun is rising and has a beautiful orange glow. The Orange Peel block was a perfect choice to celebrate this day.

NOTE: This is one post in a series of quilt-along posts. Start from the beginning with the first post [{here}](#). Block measures 5.5" square unfinished

INGREDIENTS

- 22 Layer Cakes OR 5 Fat Quarters
- 1 1/8 yards of background fabric

INSTRUCTIONS

Cutting Instructions:

Please read all instructions before you start this row.

From (7) 5.5" x WOF strips of background fabric, cut:

- 44 background squares (WITH cornerstones)
- 48 background squares (WITHOUT cornerstones)

From prints, cut:

- 176 orange peel petals (WITH cornerstones)
- 192 orange peel petals (WITHOUT cornerstones)

Sewing Instructions:

NOTE: a 5" block with 1/4" seam allowance is provided for you for petal placement. Make sure your 4 outside corners of each petal does not fall into the 1/4" seam allowance.

Use the template provided as a placement guide for orange peel applique. Using, your preferred method, applique the peels to each background square.

Assemble Rows:

WITH cornerstones

Sew (4) rows of (11) 5.5" blocks together. The top and bottom row will have (2) alternate corner blocks sewn at each end of these row.

WITHOUT cornerstones

If all 4 rows will be Orange Peel blocks, sew (2) rows of 11 blocks and two rows of 13 blocks.

Add the 11 block rows to each side of your center Medallion and 13 block rows to top and bottom of your center Medallion.

YIELD

Block measures 5.5" square unfinished

It's time for lunch and visiting Camp attendees. Hope to see you along the way.

Mary Andra Holmes

[blog: sistersquiltingtrunk.blogspot.com]

[instagram: [@MAHquilter](https://www.instagram.com/MAHquilter)]

7/22/2018

Original Recipe can be found at www.modabakeshop.com

Recipes are sometimes altered to correct errors. Please ensure that you have downloaded the most recent Printer Friendly Version before starting your project. If you find a mistake in this pattern, please contact modabakeshop@unitednotions.com.

This is an original pattern not intended for sale.

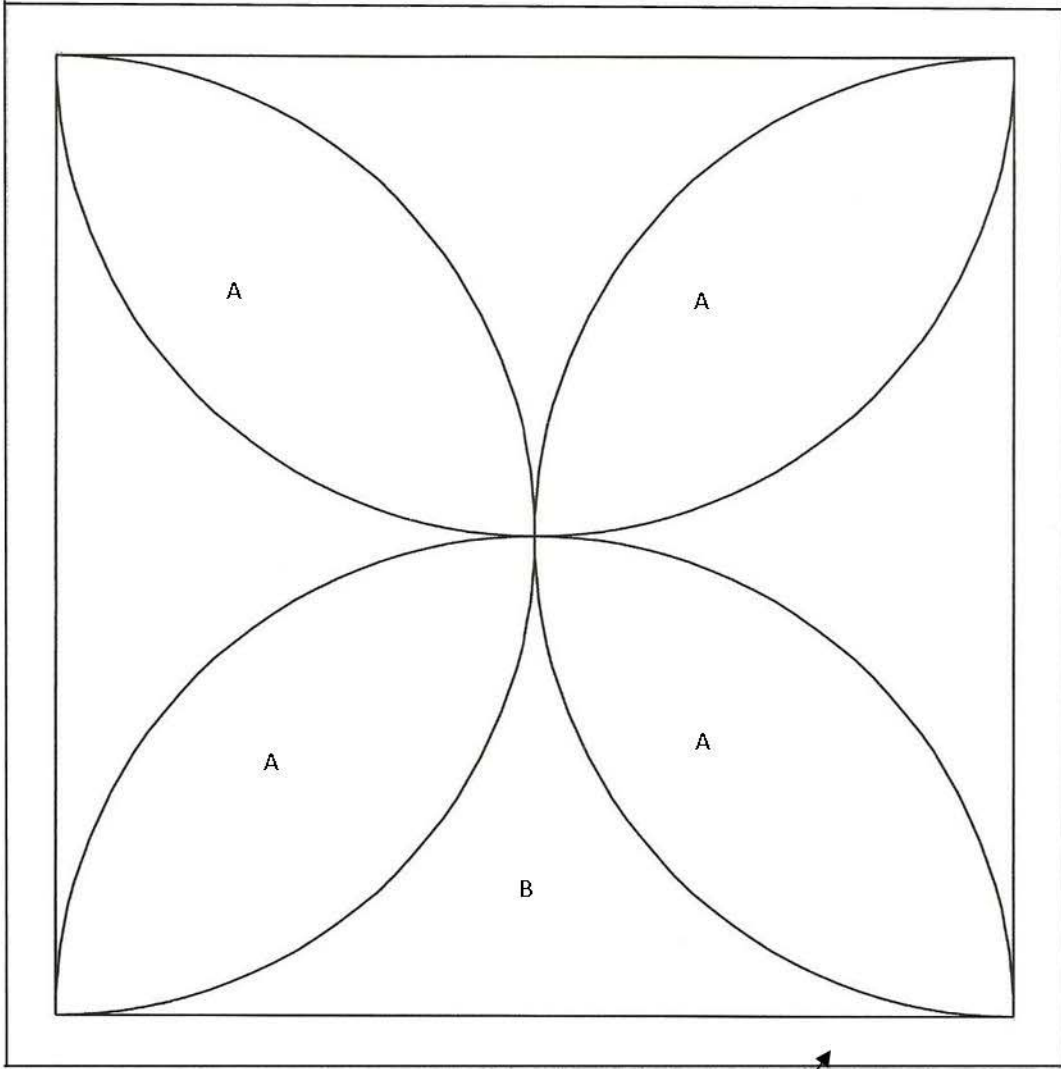

B = 5" finished block

1/4" seam allowance

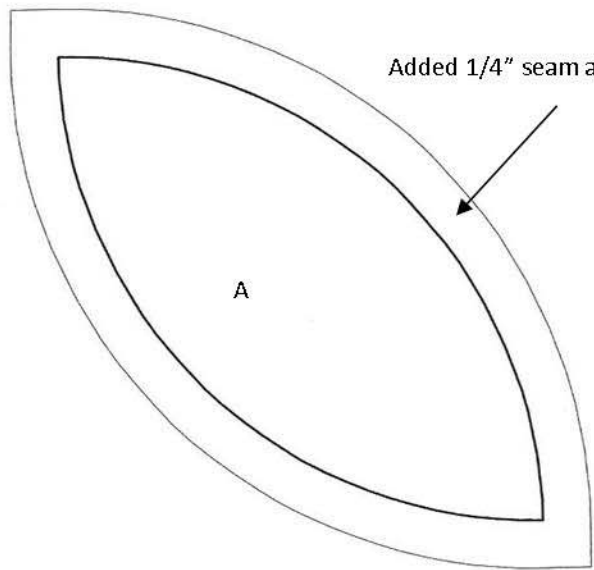

Added 1/4" seam allowance

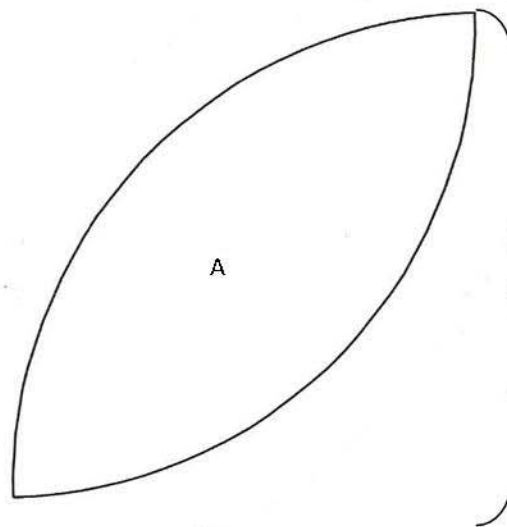

Tip to Tip

3.5" high

1 7/16"

widest point



10 Orange Peels from each Layer Cake

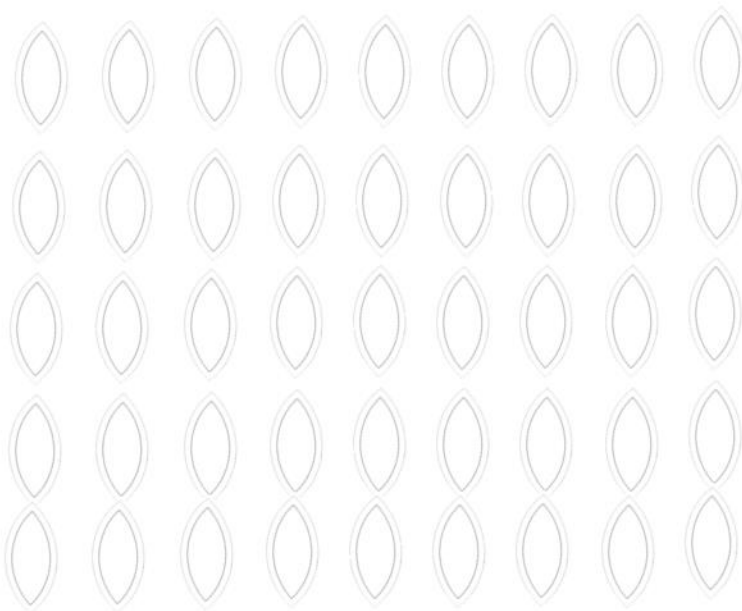

45 Orange Peels from each 18" x 22" Fat Quarter.

36 Orange Peels from each 18" x 20" Fat Quarter.

moda BAKE SHOP



MODERATE

It's family day at camp! From over the river, granny has come to see all the happenings at Camp Oda May. In her honor, we'll make one of my all-time favorite blocks, the granny square block.

NOTE: This is one post in a series of quilt-along posts. Start from the beginning with the first post [{here}](#).

INGREDIENTS

14 layer cake squares (12 if using cornerstone blocks)

OR

5 fat quarters

Whichever method you choose, you will have a bit of fabric leftover. This is done to allow some mixing among your granny squares.

INSTRUCTIONS

Cutting Instructions

If using fat quarters:

- Cut [8] 1 7/8" strips from each fat quarter (6 strips if making cornerstone blocks). Subcut each strip into [2] 8" by 1 7/8" pieces and [1] 1 7/8" square.

For a scrappier look, use 12 fat quarters and cut 3 strips from each

If using layer cakes:

- Using the following diagrams, cut the layer cakes. From 10 layer cakes (or 8 if making cornerstone blocks), cut [6] 8" by 1 7/8" pieces and [1] 1 7/8" square. From the remaining four layer cake squares, cut [5] 8" by 1 7/8" pieces and [4] 1 7/8" squares.

7/8/2018

Original Recipe can be found at www.modabakeshop.com

Recipes are sometimes altered to correct errors. Please ensure that you have downloaded the most recent Printer Friendly Version before starting your project. If you find a mistake in this pattern, please contact modabakeshop@unitednotions.com.

This is an original pattern not intended for sale.

8" by 1 7/8"					1 7/8" by 1 7/8"	1 7/8" by 1 7/8"	1 7/8" by 1 7/8"	1 7/8" by 1 7/8"			
8" by 1 7/8"	8" by 1 7/8"	8" by 1 7/8"	8" by 1 7/8"	8" by 1 7/8"	Cut 10 Layer Cake Squares this way	8" by 1 7/8"	8" by 1 7/8"	8" by 1 7/8"	8" by 1 7/8"	8" by 1 7/8"	Cut 4 Layer Cake Squares this way

Background fabric (for both layer cakes and fat quarters)

- Cut four 3 1/2" strips
- Cut three 2 1/4" strips
- Subcut into [48] 3 1/2" squares (40 if making cornerstone blocks) and [48] 2 1/4" squares (40 if making cornerstone blocks).



Assembling the granny squares:

Each granny square requires three focal fabrics and background fabric. For each, you will need:

Fabric A: [1] 1 7/8" square

Fabric B: [1] 8" by 1 7/8" piece

Fabric C: [2] 8" by 1 7/8" piece

Background fabric: [2] 3 1/2" squares and [2] 2 1/4" squares

Arrange your fabrics into 24 sets (or 20 sets if making cornerstone blocks).

For each block, sew an 8" strip of Fabric B to an 8" strip of Fabric C. Press towards Fabric C. Cut into four sets of two blocks, each 1 7/8" wide.

Cut the second 8" strip of Fabric C into four 1 7/8" squares.

Cut the 3 1/2" squares of background fabric diagonally twice, making four triangles from each square.

The background pieces are cut this way so that there are no bias edges on the outside of the quilt block. They are cut a bit oversized and will be trimmed later.

Lay your pieces out to form the granny square. Sew the pieces together in rows, with the triangles cut from the 3 1/2" squares of background fabric at the end of the rows.

Press seams towards fabrics A and C and the background fabric.

Trim the dog ears.

7/8/2018

Original Recipe can be found at www.modabakeshop.com

Recipes are sometimes altered to correct errors. Please ensure that you have downloaded the most recent Printer Friendly Version before starting your project. If you find a mistake in this pattern, please contact modabakeshop@unitednotions.com.

This is an original pattern not intended for sale.



Sew the rows together. Press towards the center. Trim dog ears.

Cut the 2 1/4" squares diagonally once, making two triangles from each square. Sew triangles to each corner, taking care to center the tip of each triangle in the square. Press towards background fabric.

Square the block up to 6 1/2", lining up the outer tips of Fabric C on the 1/4" marks.

Repeat to make a total of 24 blocks (20 if making cornerstone blocks).

Sew five granny square blocks together, pressing the seams between the blocks open. Sew to one side of the quilt.

Repeat on the other side.

Sew seven granny square blocks (or five granny square blocks with a cornerstone block on each end) together, pressing the seams between the blocks open. Sew to the top of the quilt. Repeat on the bottom.

YIELD



Christine Weld

[blog: [The Quarter Inch](#)]

[instagram: [@christine.weld](#)]

7/8/2018

Original Recipe can be found at www.modabakeshop.com

Recipes are sometimes altered to correct errors. Please ensure that you have downloaded the most recent Printer Friendly Version before starting your project. If you find a mistake in this pattern, please contact modabakeshop@unitednotions.com.

This is an original pattern not intended for sale.

 MODERATE



Welcome back campers! I'm Sharla Krenzel of Thistle Thicket Studio and I'm your camp counselor today. Ready for another Oda May Summer Camp adventure? Today we're visiting Arrowhead Lake. A picturesque setting with the deepest blue waters, the tallest trees skirting the shoreline, the biggest fish any angler would drool over, and an archery shooting range. Arrowhead Lake is down Path B, but remember, you can choose your adventure. Kristen Esser shared Path A to Geese Grove in the last post. Let's go to Arrowhead Lake....just follow the arrows!

Block measures 8.5" x 4.5" unfinished (8" x 4" finished)

INGREDIENTS

Arrowhead Lake Supplies:

- 2 Fat Quarters or 6 Layer Cake Squares for Arrowhead and Arrow Shaft
- 1 Fat Quarter or 2 Layer Cake Squares for Feather Color 1
- 1 Fat Quarter or 2 Layer Cake Squares for Feather Color 2
- 7/8 yard background fabric

INSTRUCTIONS

Cutting Instructions:

If you choose to include the cornerstones which will be introduced on Friday, you will need 20 arrow blocks and 8 arrowheads (flying geese) blocks. Cutting instructions if using cornerstones are in parenthesis. You can be adventurous and use a combination of Path A and B blocks this round, as I did in my quilt, which will change the cutting numbers depending on how many of each you choose to make.

- Arrowhead: 24 (28) - 2.5" x 4.5" rectangles*
- Arrowhead Background A: 48 (56) - 2.5" squares
- Arrow Shaft: 24 (20) - 1" x 6.5" rectangles*
- Arrow Shaft Background B: 48 (40) - 2.25" x 3.5" rectangles
- Arrow Feather Color 1: 48 (40) - 1.5" x 2.5" rectangles*
- Arrow Feather Color 2: 48 (40) - 1.5" x 2.5" rectangles*
- Arrow Feather Background C: 96 (80) - 1.5" squares
- Arrow Feathers Background D: 48 (40) - 1.25" x 3.5" rectangles

*Note: You can use a combination of print fabrics to make the total needed.

7/17/2018

Original Recipe can be found at www.modabakeshop.com

Recipes are sometimes altered to correct errors. Please ensure that you have downloaded the most recent Printer Friendly Version before starting your project. If you find a mistake in this pattern, please contact modabakeshop@unitednotions.com.

This is an original pattern not intended for sale.

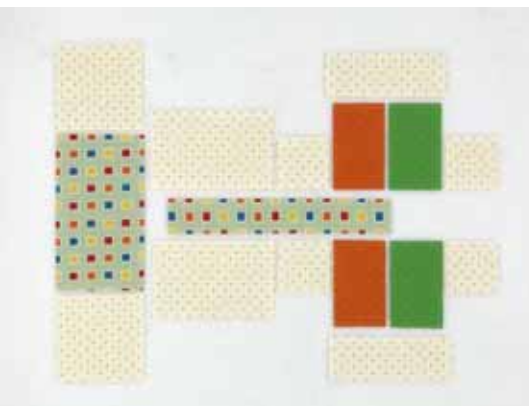
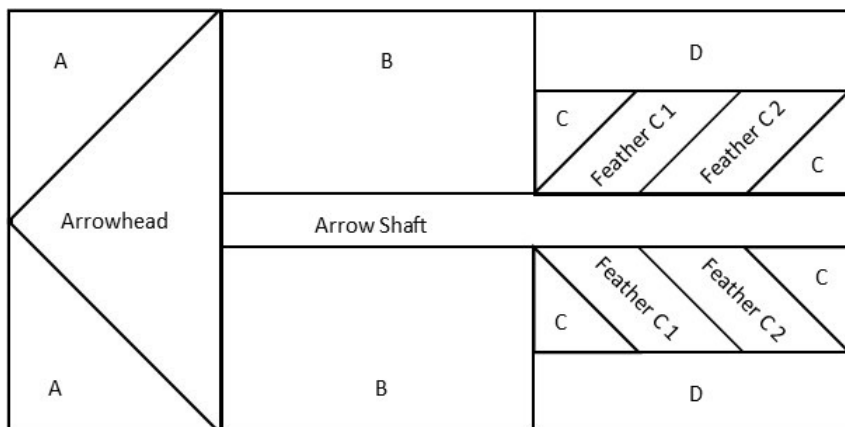

Sewing Instructions:
RST means Right Sides Together.

Arrowheads (Flying Geese):

Draw a diagonal line from corner to corner on 2 Background A squares. Layer a background square on the left side of an Arrowhead rectangle RST, with the drawn line going from the top center of the Arrowhead rectangle to the bottom left corner of the Arrowhead rectangle. Sew on the line. Trim $\frac{1}{4}$ " from sewn line. Press towards background. Lay second Background A square on the right side of the same Arrowhead rectangle RST, with the drawn line going from the top center of the Arrowhead rectangle to the bottom right corner of the Arrowhead rectangle. Sew on the line. Trim $\frac{1}{4}$ " from sewn line. Press towards background. Repeat for a total of 24 arrowheads. Square up flying geese units to measure 2.5" x 4.5".

Feather Set A:

Lay a Feather Color 1 rectangle horizontal with right side facing up. Layer a Feather Color 2 rectangle on the right side of Color 1 vertically with right side facing down and rectangle extending below the first rectangle. Draw a line on the back side of the Color 2 rectangle diagonally to the bottom right corner of the Color 1 rectangle. Sew on the line. Trim $\frac{1}{4}$ " from sewn line. Press seam open. Draw a diagonal line from corner to corner on 2 Background C squares. Layer 1 square on the Feather Color 1 side RST with the line going from the upper left corner to the lower right corner. Sew on the line. Trim $\frac{1}{4}$ " from sewn line. Press seam open. Layer the other Background C square on the Feather Color 2 side RST with the line going from the upper left corner to the lower right corner. Sew on the line. Trim $\frac{1}{4}$ " from sewn line. Press seam open.

Sew a Background D rectangle to the bottom of the feather unit. Press seam towards background. Sew a Background B rectangle to the left side of the feather unit. Press seam towards background. Unfinished unit should measure 2.25" x 6.5". Make a total of 24 units of Feather Set A.

7/17/2018

Original Recipe can be found at www.modabakeshop.com

Recipes are sometimes altered to correct errors. Please ensure that you have downloaded the most recent Printer Friendly Version before starting your project. If you find a mistake in this pattern, please contact modabakeshop@unitednotions.com.

This is an original pattern not intended for sale.

Tip: Pay close attention to placement and direction of the feather pieces or you'll be singing our least favorite campfire song - the "Rippit, Rippit Blues"!

Hint: Chain stitching each step of this unit will speed up the sewing process.

Feather Set B:

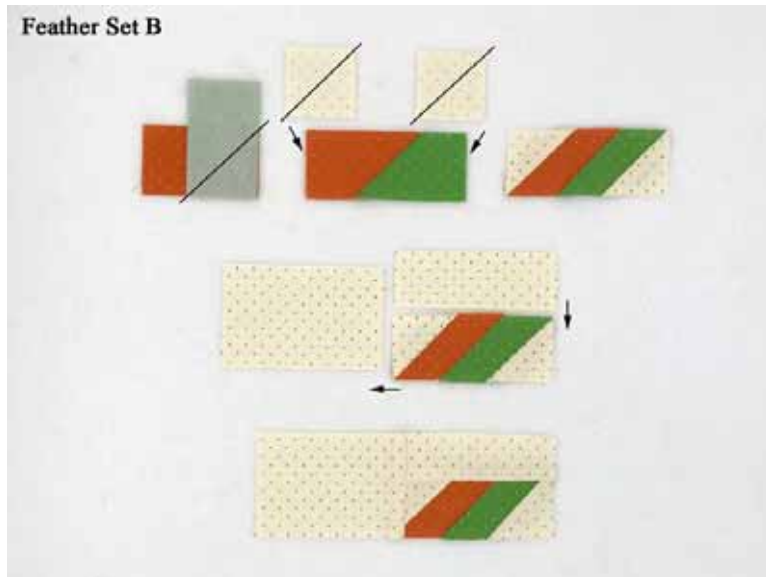

Lay a Feather Color 1 rectangle horizontal with right side facing up. Layer a Feather Color 2 rectangle on the right side of Color 1 vertically with right side facing down and rectangle extending above the first rectangle. Draw a line on the back side of the Color 2 rectangle from the lower left corner of the Color 2 rectangle diagonally to the top right corner of the Color 1 rectangle. Sew on the line. Trim $\frac{1}{4}$ " from sewn line. Press seam open.

Draw a diagonal line from corner to corner on 2 Background C squares. Layer 1 square on the Feather Color 1 side RST with the line going from the lower left corner to the upper right corner. Sew on the line. Trim $\frac{1}{4}$ " from sewn line. Press seam open.

Layer the other Background C square on the Feather Color 2 side RST with the line going from the lower left corner to the upper right corner. Sew on the line. Trim $\frac{1}{4}$ " from sewn line. Press seam open.

Sew a Background D rectangle to the top of the feather unit. Press seam towards background.

Sew a Background B rectangle to the left side of the feather unit. Press seam towards background. Unfinished unit should measure 2.25" x 6.5". Make a total of 24 units of Feather Set A.

Completing the block:

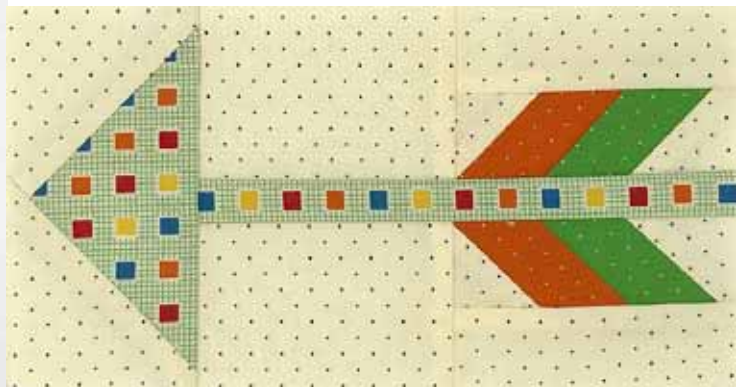
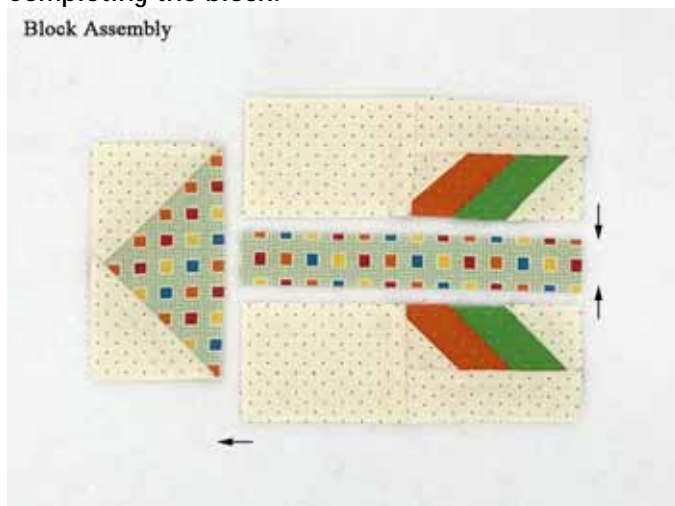

Sew the Arrow Shaft to the top of Feather Set A. Press seam towards shaft.

Sew bottom of Feather Set B to the Arrow Shaft. Press seam towards shaft.

Sew the Arrowhead to the shaft side of the Feather unit. Press seam towards arrowhead. Unfinished block should measure 4.5" x 8.5". Repeat for a total of 24 blocks.

Assembly of Rows:

7/17/2018

Original Recipe can be found at www.modabakeshop.com

Recipes are sometimes altered to correct errors. Please ensure that you have downloaded the most recent Printer Friendly Version before starting your project. If you find a mistake in this pattern, please contact modabakeshop@unitednotions.com.

This is an original pattern not intended for sale.



Sew 6 Arrow blocks short end to short end. Press seams open. You can choose to face your arrows in any direction you choose. Row should measure 4.5" x 48.5". Repeat to make 4 sets.

Choose Your Adventure - Take Both Paths! To add interest, you can choose to substitute Flying Geese blocks for some of the Arrow blocks. For each Arrow block per side, you will need to replace with 4 Flying Geese blocks.

Sewing Rows to Medallion:

To sew the rows onto your medallion, you will be using a process called Partial Seams. Your row will be 4 inches longer than your medallion. Starting at the top left corner of the medallion, place your row edge flush with the edge of the medallion and pin. At the other end of your row, measure in 4" and pin the medallion edge at that 4" mark. Pin the row along the remainder of the top edge of the medallion. Starting at the flush edge, sew the row to the medallion, stopping 3" before you get to the edge of the medallion. Press seam towards the medallion.

Now the left side of the medallion is the same length as your Arrow row. Pin and sew an arrow row to the left side of the medallion. Press seam towards the medallion. Repeat sewing a row to the bottom of the medallion, then a row to the right side of the medallion. Now finish sewing the partial seam of the first row to the medallion. Your medallion should measure 52.5" x 52.5".

Note: To avoid attaching the Arrow block rows using the partial seam method, you can remove one Arrow block from 2 rows (from 6 blocks to 5 blocks) and add 2 flying geese blocks anywhere within the row that you like. The row will measure 4.5" x 44.5". Sew a row on the left and right side of the medallion. To the 2 remaining rows of 6 blocks, add 2 flying geese blocks anywhere within the row that you like. The row will measure 4.5" x 52.5". Sew a row on the top and bottom of the medallion.

Cornerstone Note: If you choose to include the cornerstone option that will be shared on Friday, you will need to make 4 block strip sets of 5 blocks and 2 flying geese blocks. Sew two of the block strip sets to the right and left sides of your medallion square. Sew a cornerstone block on each end of the remaining two strip sets and sew them to the top and bottom of the medallion square.



YIELD

Your medallion should measure 52.5" x 52.5".

I hope you are enjoying Oda May's Summer Camp as much as I am! I've been taking lots of photos while at camp and you can follow me as I sew along with all of you on this QAL adventure at any of the links below.

Sharla Krenzel

Instagram {[@thistlethicketstudio](https://www.instagram.com/thistlethicketstudio)}

Facebook {[Thistle Thicket Studio](https://www.facebook.com/ThistleThicketStudio)}

Blog {www.thistlethicketstudio.com}

7/17/2018

Original Recipe can be found at www.modabakeshop.com

Recipes are sometimes altered to correct errors. Please ensure that you have downloaded the most recent Printer Friendly Version before starting your project. If you find a mistake in this pattern, please contact modabakeshop@unitednotions.com.

This is an original pattern not intended for sale.

moda BAKE SHOP



EASY

Hello fellow campers! I'm Sharla Krenzel of Thistle Thicket Studio and I'm so happy that you joined me at my cabin at Camp Oda May. Today we're going on a hike and the first thing we'll encounter on our adventure is a fork in the road where we'll choose Path A or Path B. I'll be your guide if you choose Path B which will lead us to Cross Creek. Mona Phelps will be your guide should you choose Path A that will lead you to Four Points, which was posted on Monday, July 2. Let's take a hike!



After a short hike down Path B we arrive at Cross Creek. There are a couple of ways to cross the creek, which I will share both options with you today.

INGREDIENTS

Cross Creek Crossing 1 Supplies:

- 1 Fat Quarter or 2 Layer Cake Squares of a medium/color 1 print fabric
- 1 Fat Quarter or 2 Layer Cake Squares of a dark/color 2 print fabric
- 1 Fat Quarter or 9" x WOF of background fabric

Cross Creek Crossing 2 Supplies:

- 1 Fat Quarter or 2 Layer Cake Squares of a medium/color 1 print fabric
- 1 Fat Quarter or 2 Layer Cake Squares of a dark/color 2 print fabric
- 1 Fat Quarter or 1 Layer Cake Square of a light/color 3 print fabric
- 1 Fat Quarter or 9" x WOF of background fabric

INSTRUCTIONS

Note: There is a new adventure coming - cornerstones!! On Friday, a cornerstone option for this round will be posted. Should you choose to include the cornerstones in this round, you will only need to make 28 blocks (14 medium and 14 dark) instead of 32. In parentheses are the cutting instructions for the Cross Creek block if you plan to make the cornerstones.

Cutting Instructions for Crossing 1:

- 32 (28) - 1 1/2" squares from medium/color 1 fabric
- 16 (14) - 1 1/2" x 3 1/2" rectangles from medium/color 1 fabric
- 32 (28) - 1 1/2" squares from dark/color 2 fabric
- 16 (14) - 1 1/2" x 3 1/2" rectangles from dark/color 2 fabric

7/10/2018

Original Recipe can be found at www.modabakeshop.com

Recipes are sometimes altered to correct errors. Please ensure that you have downloaded the most recent Printer Friendly Version before starting your project. If you find a mistake in this pattern, please contact modabakeshop@unitednotions.com.

This is an original pattern not intended for sale.

- 128 (112) - 1 1/2" squares from background fabric

Cutting Instructions For Crossing 2:

- 64 (56) - 1 1/2" squares from medium/color 1 fabric
- 64 (56) - 1 1/2" squares from dark/color 2 fabric
- 32 (28) - 1 1/2" squares from light/color 3 fabric
- 128 (112) - 1 1/2" squares from background fabric

Sewing Instructions:

CROSS CREEK

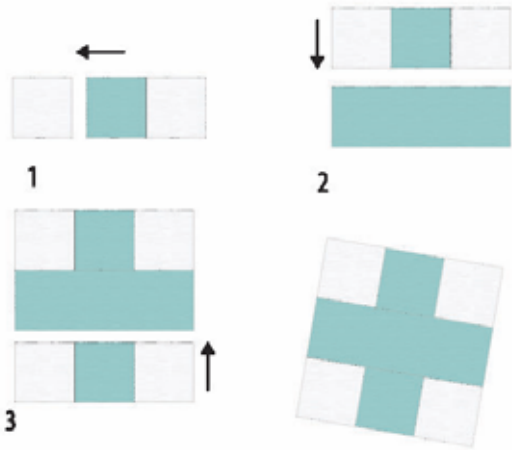

1. Sew a 1 1/2" background square on either side of a 1 1/2" color 1 square. Press seams towards the background squares. Repeat for a total of 32 (28) sets of color 1 and 32 (28) sets of color 2.

**Tip: This is a good time to check the accuracy of your 1/4" seam allowance. Measure the length of your 3 square unit. It should measure 3 1/2". If it is smaller than 3 1/2", adjust your needle to the right to sew a smaller seam. If your unit measures larger than 3 1/2", adjust your needle to the left to sew a larger seam.*

2a. Sew a 3 square color 1 unit on either side of the long side of a 1 1/2" x 3 1/2" color 1 rectangle. Press seams toward the center strip. Repeat for a total of 16 (14) color 1 Cross Creek blocks and 16 (14) color 2 Cross Creek blocks.

For Crossing 2:

2b. Sew a 1 1/2" color 1 square on either side of a 1 1/2" color 3 square. Press seams towards the center. Repeat for a total of 16 (14) sets of color 1 and 16 (14) sets of color 2.

3. Sew a 3 square color 1 unit from Step 1 on either side of the long side of the 3 square color 1 unit just sewn in Step 2. Press seams towards the center. Repeat for a total of 16 (14) color 1 Cross Creek blocks and 16 (14) color 2 Cross Creek blocks.

Unfinished block should measure 3 1/2" square (finished 3" square).

Completing the Border for both Crossing 1 & 2:

Step 1: Sew 7 blocks together in a strip, alternating color 1 & 2 blocks, starting and ending with color 1 blocks. When sewing your blocks together, rotate blocks so that the seams nest together to reduce bulk and to help with matching corners. Repeat for a total of 2 block strips. Block strips should measure 21 1/2" long. Sew one strip on the right and one strip on the left of your center medallion + 1st border square.

Step 2: Sew 9 (7) blocks together in a strip, alternating color 1 & 2 blocks, starting and ending with color 2 blocks. Repeat for a total of 2 block strips. Block strips should measure 27 1/2" (21 1/2") long. Sew one strip on the top and one strip on the bottom of your center medallion + 1st border square.

Note: If you plan to include the cornerstones options in this round, use the numbers in parentheses in Step 2. Once your cornerstone blocks are completed, sew one block on each end of the Step 2 strips. Block strips should measure 27 1/2" long. Then continue sewing on the block strips as instructed in Step 2.



YIELD

Your unfinished medallion square should measure 27 1/2" x 27 1/2".

I hope you enjoyed our little hike today! I'll be back in a couple of weeks to take you on another adventure. In the meantime, you can follow me as I sew along with all of you on this QAL adventure on Instagram @thistlethicketstudio, on Facebook at <https://www.facebook.com/thistlethicketstudio/> or on my blog at www.thistlethicketstudio.com where I'll be sharing sewing tips for this QAL.

Sharla Krenzel

www.thistlethicketstudio.com

7/10/2018

Original Recipe can be found at www.modabakeshop.com

Recipes are sometimes altered to correct errors. Please ensure that you have downloaded the most recent Printer Friendly Version before starting your project. If you find a mistake in this pattern, please contact modabakeshop@unitednotions.com.

This is an original pattern not intended for sale.

moda BAKE SHOP



Hi, Everyone! It's Jessica of [Skein and Hook](#) here. Today we are heading to Pinwheel Point! I'm so excited to take this journey with you. Let's go!

NOTE: This is one post in a series of quilt-along posts. Start from the beginning with the first post [here](#).

INGREDIENTS

14 layer cake squares (12 if using cornerstone blocks)

OR

5 fat quarters from the main fabric

AND

1/2 yard of background fabric

INSTRUCTIONS

These blocks will measure 6.5" unfinished (6" finished).

NOTE ON CORNERSTONES: Later this week you will find out about cornerstone options for this round. If you choose to NOT use cornerstones, you will need 24 finished Pinwheel Point blocks. If you decide you want to include cornerstones, you will only need 20 finished Pinwheel Point blocks. The fabric requirements and directions are for all 24 blocks.

CUTTING INSTRUCTIONS

From your background fabric (for both layer cakes and fat quarters), cut 3- 4.25" x WOF strips; subcut into 24- 4.25" squares. Subcut on both diagonals to yield 4 triangles.

From your main fabrics, cut 24- 4.25" squares (this will form the background pinwheel with the background fabric*). Subcut on both diagonals to yield 4 triangles.

From your main fabrics, cut 24- 4.75" squares (this will be for the center square in the middle of the pinwheel*).

*You can choose to do all one color/one shade for the pinwheel and cut all of the squares from that color/shade or you can choose to cut from a few to make it scrappy-looking.



The block layout is as shown below.

7/10/2018

Original Recipe can be found at www.modabakeshop.com

Recipes are sometimes altered to correct errors. Please ensure that you have downloaded the most recent Printer Friendly Version before starting your project. If you find a mistake in this pattern, please contact modabakeshop@unitednotions.com.

This is an original pattern not intended for sale.



Sew the background triangles and the main triangles together as shown (along one of the short sides with the background fabric on the left and the main fabric on the right). Repeat for all 4. Press the seam allowance to the darker fabric.

Fold your middle square in half and finger press each middle point. Open and fold the other way, finger press each middle point. This will make it so that you can easily see the middle point of each side.

Line up the seam and the finger pressed middle point on one side. Sew together. Then, directly across the the side you just sewed, line up the seam and the finger pressed middle point on one side. Sew together. Press the seam allowance toward the middle square.



Trim off the dog ears.

Sew on the two remaining sides using the same technique. Press the seam allowance away from the center square. Trim the square to 6.5".

One block is finished! Repeat to make 24 total blocks.

ASSEMBLY

If you are NOT doing cornerstones, sew 2 sets of 6 blocks each and 2 sets of 5 blocks each. Sew the 5 block sets to the left and right of the medallion. Then sew the 6 block sets to the top and bottom of the medallion.

If you are going to use the cornerstones that will be given later this week, sew 4 sets of 5 blocks each. Sew a 5 block set to the left and right of the medallion. Wait of the cornerstone directions before adding the top and the bottom set.

YIELD



Jessica Dayon

[blog: [Skein and Hook](#)]

[instagram: [@skeinandhook](#)]

7/10/2018

Original Recipe can be found at www.modabakeshop.com

Recipes are sometimes altered to correct errors. Please ensure that you have downloaded the most recent Printer Friendly Version before starting your project. If you find a mistake in this pattern, please contact modabakeshop@unitednotions.com.

This is an original pattern not intended for sale.

Match the two main squares and the two background squares right sides together. Draw a line down the middle on each and sew 1/4" on each side of the line.

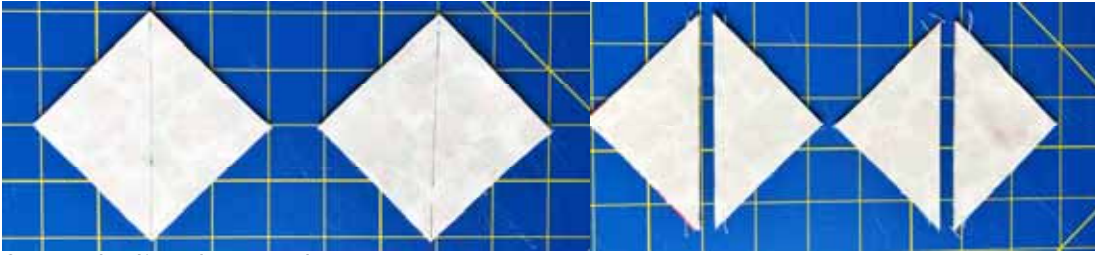

Cut on the line that you drew.

Press the HST with the seam allowance going toward the darker fabric. The HST should measure 2.5" unfinished. If not, trim to that size.

Sew the block into rows.



Press the seams so that they will nest when you assemble the rows.

Sew the rows together into a block.

One block is finished! Repeat to make 48 total blocks.

A NOTE ABOUT COLOR PLACEMENT: Each block will use HST made from background fabric and main fabric. You can alternate the way you place the HST to give the round some more interest, which is the way I'll be making my round. If you'd like to do it like this as well, you will need 24 of each type shown below. If you are going to use cornerstones, you will need 24 of one type and 20 of the other type.



ASSEMBLY

If you are NOT doing cornerstones, sew 2 sets of 11 blocks each and 2 sets of 13 blocks each. Sew the 11 block sets to the left and right of the medallion. Then sew the 13 block sets to the top and bottom of the medallion.

If you are going to use the cornerstones that will be given later this week, sew 4 sets of 11 blocks each. Sew a 11 block set to the left and right of the medallion. Wait of the cornerstone directions before adding the top and the bottom set.

Jessica Dayon

[blog: [Skein and Hook](#)]

[instagram: [@skeinandhook](#)]

7/24/2018

Original Recipe can be found at www.modabakeshop.com

Recipes are sometimes altered to correct errors. Please ensure that you have downloaded the most recent Printer Friendly Version before starting your project. If you find a mistake in this pattern, please contact modabakeshop@unitednotions.com.

This is an original pattern not intended for sale.



MODERATE

On Monday Camp Counselor Mary shared the first center block option, [Dresden Peak](#), and today we have the second of option for you: Star Valley! Either of these choices will make a perfect center for the Choose Your Own Adventure medallion quilt. Which one are you going to choose?

NOTE: This is one post in a series of quilt-along posts. Start from the beginning with the first post [here](#).

Hi! It's Kristina Brinkerhoff from Center Street Quilts and I'm excited to be presenting the second option for the center block today: Star Valley. The Star Valley block is a fun, traditionally pieced star that is easy and quick to sew together. It would make the perfect center to your Medallion Quilt, but then again, so would the Dresden Peak! Have you decided which one you'll choose yet?

The Star Valley center medallion option finishes at 20" x 20".

INGREDIENTS

- 10" x WOF for the Background Fabric, plus either:
- 2 Fat Quarters (1 dark, 1 medium/light) OR 5 Layer Cake squares (10" x 10" squares) (2 dark, 3 medium/light)

A few notes about the Ingredients for each option: as you might have noticed, the fabric requirements for the Star Valley center block option are different than the Dresden Peak option. This will be the case each week as we go through the Choose Your Own Adventure QAL. We did our best to combine all of the fabric requirements to give an accurate estimate of what you'll need overall, but you will likely have a little extra fabric at the end (too much is way better than running out, right!?!). Additionally, for most of the options, you'll have sections of fat quarters or layer cake squares left over to use for another week. Feel free to use the half of a fat quarter left over from this week on next week's blocks. Or, if you want to add in more color variety, you can absolutely use more fat quarters or layer cakes than what is listed--knowing that everything will even out as you work your way through the quilt top. Be creative and know that you can definitely make changes as you go. :)

6/26/2018

Original Recipe can be found at www.modabakeshop.com

Recipes are sometimes altered to correct errors. Please ensure that you have downloaded the most recent Printer Friendly Version before starting your project. If you find a mistake in this pattern, please contact modabakeshop@unitednotions.com.

This is an original pattern not intended for sale.

INSTRUCTIONS

Before beginning:

- Read through the entire instructions
- Seams are all 1/4"
- Width of Fabric is abbreviated as WOF and is assumed to be 42".

Cutting Instructions

Below, you'll find the cutting instructions for both Fat Quarters and Layer Cakes. Only follow the set of instructions that corresponds to the fabric precut you are using. EVERYONE needs to cut the Background Fabric the same. :)

Cutting the Fat Quarters (follow only if you are using FQs):

From one fat quarter (dark color) cut:

- (4) 5" x 5" squares
- (4) 1.5" x 3.5" strips
- (4) 1.5" x 2.5" strips
- (4) 1.5" x 1.5" squares
- (1) 4.5" x 4.5" square (this will be the center square. You can choose to cut this square from a third fat quarter to make this center square really stand out)

From one fat quarter (medium/light color) cut:

- (4) 4.5" x 4.5" squares
- (4) 1.5" x 4.5" strips
- (4) 1.5" x 3.5" strips
- (4) 1.5" x 2.5" strips
- (4) 1.5" x 1.5" squares

Cutting the Layer Cakes (follow only if you are using Layer Cakes):

From one layer cake square (dark color) cut:

- (4) 1.5" x 3.5" strips
- (4) 1.5" x 2.5" strips
- (4) 1.5" x 1.5" squares

From one layer cake square (dark color) cut:

- (4) 5" x 5" squares

From one layer cake square (medium or light color) cut:

- (4) 4.5" x 4.5" squares

From one layer cake square (medium or light color) cut:

- (4) 1.5" x 4.5" strips
- (4) 1.5" x 3.5" strips
- (4) 1.5" x 2.5" strips
- (4) 1.5" x 1.5" squares

From one layer cake square (medium or light color) cut:

- (1) 4.5" x 4.5" square (this will be the center square of the star)

Background Fabric (EVERYONE cut this):

- Cut (1) 4.5" x WOF strip. Subcut into (8) 4.5" x 4.5" squares.
- Cut (1) 5" x WOF strip. Subcut into (4) 5" x 5" squares.

Assembling the Block

First, we will assemble the half-square triangles.

HALF-SQUARE TRIANGLES (HSTs)

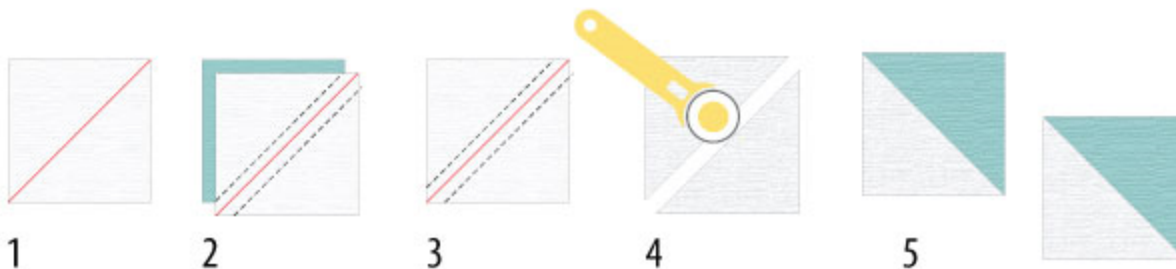

6/26/2018

Original Recipe can be found at www.modabakeshop.com

Recipes are sometimes altered to correct errors. Please ensure that you have downloaded the most recent Printer Friendly Version before starting your project. If you find a mistake in this pattern, please contact modabakeshop@unitednotions.com.

This is an original pattern not intended for sale.

1. Gather the (4) background 5" x 5" squares and draw a line diagonally corner-to-corner on the wrong side of the fabric.
 2. Pair a dark color 5" x 5" square right sides together with each of the background squares.
 3. Sew each pair of squares together using two seams, 1/4" away from either side of the drawn line.
 4. Cut the pairs apart on the drawn line and press the seam open.
 5. There should now be (8) half-square triangles. Trim the squares to 4.5" x 4.5".
- Next, we will assemble the quarter log cabin blocks.

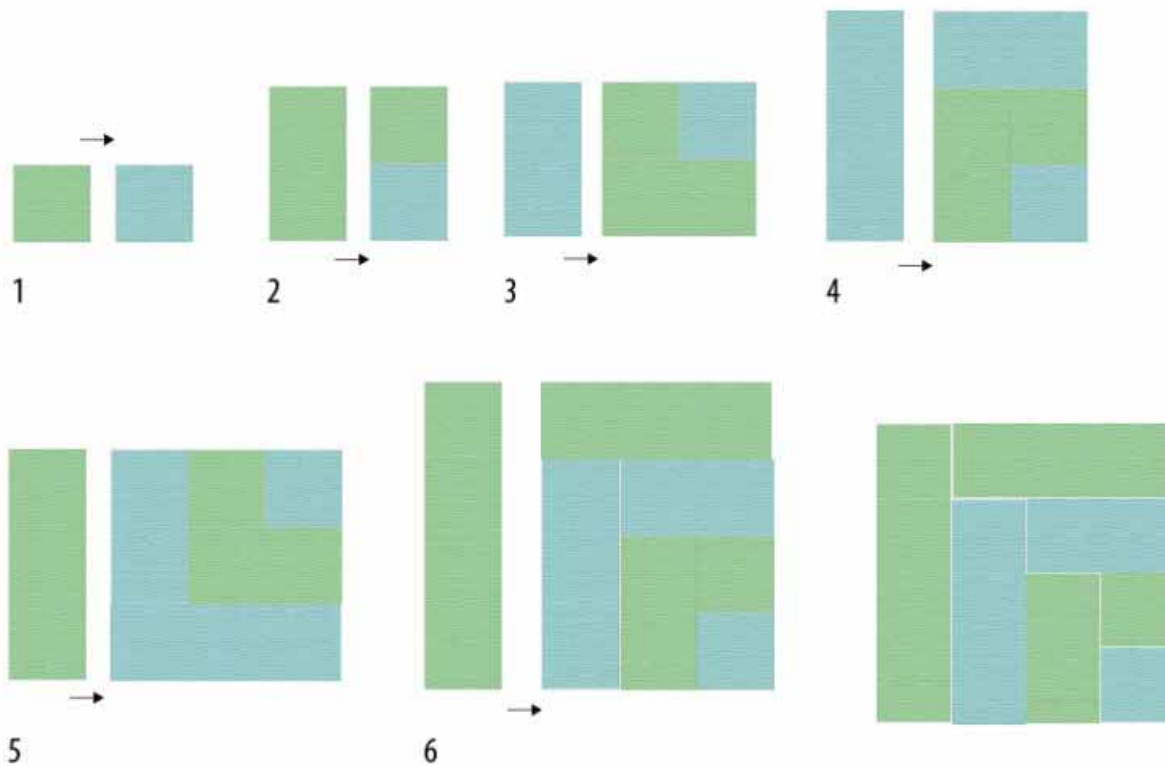

1. Pair up a dark 1.5" square with a medium/light 1.5" square and sew them along one edge, right sides together. Press the seam toward the dark square.
2. Orient the newly sewn square units so the dark square is always in the lower left corner. Take one of the medium/light 1.5" x 2.5" strips and add it to the side of one of the 1.5" square units that was just sewn, as shown. Press the seam toward the newly sewn strip.
3. Again, orient the sewn unit so the dark square is at the lower left corner. Take one of the dark 1.5" x 2.5" strips and sew it, right sides together, to the top of the unit. Press the seam toward the newly sewn strip.
4. With the dark square still in the lower left corner, take a dark 1.5" x 3.5" strip and add it to the right side of the sewn unit. Press the seam toward the newly sewn strip. Add the 1.5" x 3.5" medium/light strips to the tops of the units. Press toward the newly sewn strips.
5. Add the 1.5" x 4.5" medium/light strips to the right sides of the units. Again, press toward the newly sewn strips.

The quarter log cabin units should measure 4.5" x 4.5" each. Repeat to make 3 quarter log cabin units.

Lay out the pieces in a 5 x 5 grid as shown in the image below. Assemble each of the five rows, pressing the seams in alternating directions.

6/26/2018

Original Recipe can be found at www.modabakeshop.com

Recipes are sometimes altered to correct errors. Please ensure that you have downloaded the most recent Printer Friendly Version before starting your project. If you find a mistake in this pattern, please contact modabakeshop@unitednotions.com.

This is an original pattern not intended for sale.

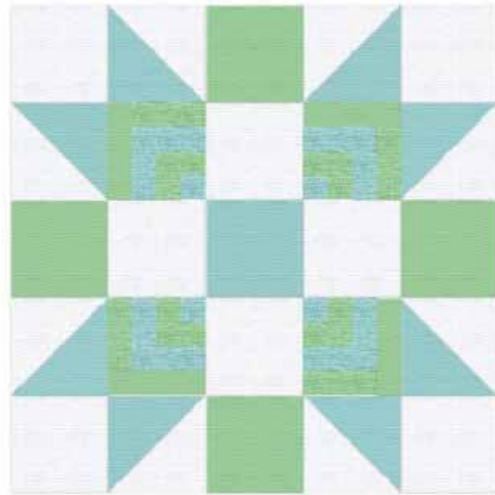
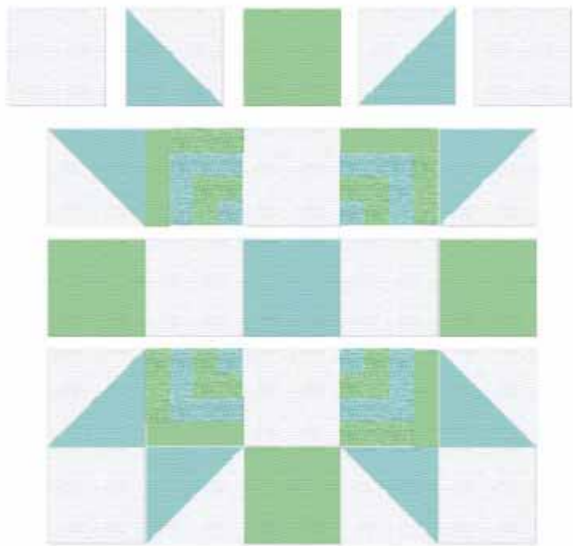

Sew the rows together, pressing the seams all in one direction.

The completed Star Valley block should measure 20.5" x 20.5" (and will finish at 20" x 20").

One note about medallion quilts: it is pretty important that each block or border measures accurately. Since you will be adding border after border to this center block, being off by a little bit can really affect the borders to come. But if accuracy isn't your forte, you don't need to fear! After each block or border, we will add in a filler border made with the background fabric. This filler border is your chance to square the quilt up or down to the right size. So if you're measuring small, make the filler border bigger. If you're measuring big, sew on the filler border then trim to size. This adjustment will help ensure that the next border fits on correctly. :)

YIELD

The Star Valley block finishes at 20" x 20" (measures at 20.5" x 20.5" unfinished).



What a fun start to the Choose Your Own Adventure Quilt Along, right? The Dresden Peak and Star Valley blocks are both such great options and I'm excited to see everyone's fabric choices and progress on their own medallion quilts. Next week there will be two options for the first pieced border and I'm already itching to get going on it. :) To follow along with my medallion quilt progress, you can check out my instagram account [@centerstreetquilts](#) or Facebook page [HERE](#). I'll be posting updates on both of those regularly. If you're also posting on social media, please use the hashtag #ChooseYourOwnAdventureQAL so we can see your progress, too. Happy sewing!

Kristina Brinkerhoff

[blog: [Center Street Quilts](#)]

[instagram: [@centerstreetquilts](#)]

6/26/2018

Original Recipe can be found at www.modabakeshop.com

Recipes are sometimes altered to correct errors. Please ensure that you have downloaded the most recent Printer Friendly Version before starting your project. If you find a mistake in this pattern, please contact modabakeshop@unitednotions.com.

This is an original pattern not intended for sale.



EASY

We have reached the end of Week 1 of our Choose Your Own Adventure Quilt-Along! You've seen the choices for Path A and Path B centers. Which adventure did you choose?!

NOTE: This is one post in a series of quilt-along posts. Start from the beginning with the first post [{here}](#). Next week we will have two options for the latest Round-about our medallion - Path A on Monday and Path B on Wednesday. We will stick to this routine for the rest of our time here at camp. Typically our border posts will fall on Sunday to go along with Sunday Social and Fridays will be reserved for the optional cornerstones. Confusing? Don't worry! Just keep checking back in, download [this printable](#), and you will be on your own path to adventure in no time.

INGREDIENTS

- (2) 1" x 20.5" strips for top/bottom borders
- (2) 1" x 21.5" strips for side borders

We suggest using background fabric for this border but if you want to make it pop, by all means - pop away!

INSTRUCTIONS

Lightly starch and press your completed medallion center block. Square it up to 20.5" x 20.5".

Sew 1" x 20.5" strips to the top and bottom of your block. Press.

Sew 1" x 21.5" strips to each side of your block. Press, lightly starch, and press the whole block one more time.

YIELD

The medallion center + border should measure 21.5" square. And that's it for this week! See you back here for Sunday Social.

Oda May

[Facebook page: [facebook.com/ModaBakeShop/](https://www.facebook.com/ModaBakeShop/)]

[Facebook group: [facebook.com/groups/MBSbakers/](https://www.facebook.com/groups/MBSbakers/)]

[Instagram: [@modabakeshop/](https://www.instagram.com/modabakeshop/)]

6/29/2018

Original Recipe can be found at www.modabakeshop.com

Recipes are sometimes altered to correct errors. Please ensure that you have downloaded the most recent Printer Friendly Version before starting your project. If you find a mistake in this pattern, please contact modabakeshop@unitednotions.com.

This is an original pattern not intended for sale.

EASY

Welcome to another Sunday Social and the end of Week 2 of the Choose Your Own Adventure Quilt-Along!

NOTE: This is one post in a series of quilt-along posts. Start from the beginning with the first post [here](#).

We have a lot going on at summer camp! If you are just joining in, this is where we are on our journey:

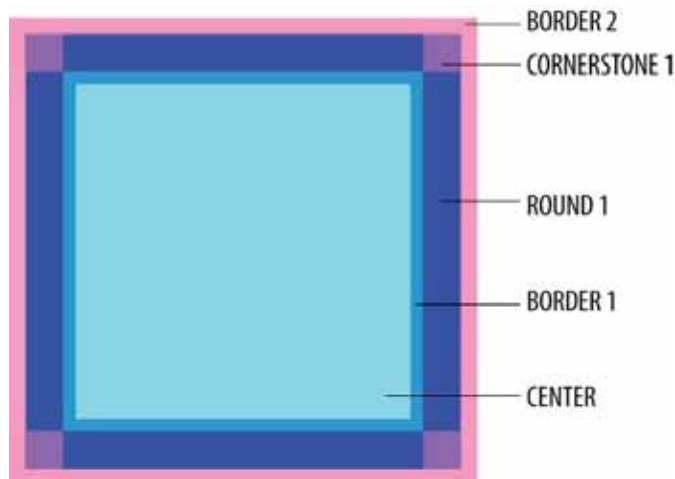

For instructions for the previous posts, click on the links below:

- [Center \(Path A\) - Dresden Peak](#)
- [Center \(Path B\) - Star Valley](#)
- [Border 1](#)
- [Round 1 \(Path A\) - Four Points](#)
- [Round 1 \(Path B\) - Cross Creek](#)
- [Cornerstone 1 - Tulip Field](#)
- [Border 2 \(this post\)](#)

If you get lost along the way, just click on the [Index](#) tab at the top of the blog to see all of the links to the QAL posts in order.

Today's post has the (very quick and easy!) instructions for Border 2 and then please pop over to our social accounts to see what everyone else is sewing together. You will find a TON of inspiration. Quilters are really taking this quilt and making it their own which is exactly what we hoped for when we designed it.

Now on to Border 2!

INGREDIENTS

- (2) 2" x 27.5" strips for top/bottom borders
- (2) 2" x 30.5" strips for side borders

Once again, feel free to make this border pop with a print!

INSTRUCTIONS

Lightly starch and press your completed medallion center block + Round 1. Square it up to 27.5" x 27.5".

Sew 2" x 27.5" strips to the top and bottom of your block. Press.

Sew 2" x 30.5" strips to each side of your block. Press seams, lightly starch, and then press the whole block one more time.

YIELD

The medallion quilt should measure 30.5" square. And that's it for this week! See you back here tomorrow for Round 3 - Path A.

Oda May

[Facebook page: facebook.com/ModaBakeShop]

[Facebook group: facebook.com/groups/MBSbakers]

[Instagram: [@modabakeshop](https://instagram.com/modabakeshop)]

7/8/2018

Original Recipe can be found at www.modabakeshop.com

Recipes are sometimes altered to correct errors. Please ensure that you have downloaded the most recent Printer Friendly Version before starting your project. If you find a mistake in this pattern, please contact modabakeshop@unitednotions.com.

This is an original pattern not intended for sale.

EASY

Welcome to another Sunday Social and the end of Week 3 of the **Choose Your Own Adventure Quilt-Along!** Today we have the super easy instructions for Border 3 plus some tips and answer to frequently asked questions over the past week.

NOTE: This is one post in a series of quilt-along posts. Start from the beginning with the first post [{here}](#).

We have traveled from Dresden Peak to Four Points and Over the River to Star View! There are a lot of posts each week so we will be sharing the links here every Sunday as we check in.

For instructions for the previous posts, click on the links below:

- [Center \(Path A\) - Dresden Peak](#)
- [Center \(Path B\) - Star Valley](#)
- [Border 1](#)
- [Round 1 \(Path A\) - Four Points](#)
- [Round 1 \(Path B\) - Cross Creek](#)
- [Cornerstone 1 - Tulip Field](#)
- [Border 2](#)
- [Round 2 \(Path A\) - Over the River](#)
- [Round 2 \(Path B\) - Pinwheel Point](#)
- [Cornerstone 2 - Star View](#)
- [Border 3 \(this post\)](#)



If you get lost along the way, just click on the [Index](#) tab at the top of the blog to see all of the links to the QAL posts in order.

INGREDIENTS

- (2) 1.5" x 42.5" strips for top/bottom borders
- (2) 1.5" x 44.5" strips for side borders

NOTE: The fabric requirements were calculated to use background fabric for this border but feel free to make this border pop with a print! This is the first week that our borders are getting very close to WOF (width of fabric). You should cut (5) 1.5" strips of border fabric, remove selvages, sew strips end-to-end, and subcut the long strip into the lengths listed. This is the method that should be used to make borders from this week on.

INSTRUCTIONS

Lightly starch and press your completed medallion (center block + Round 1 + Round 2). Square it up to 42.5" x 42.5". Sew 1.5" x 42.5" strips to the top and bottom of your block. Press.

Sew 1.5" x 44.5" strips to each side of your block. Press seams, lightly starch, and then press the whole block one more time.

YIELD

The medallion quilt should measure 44.5" square.

Have a great day, Campers! We have lots more planned for you this week so get some rest after you get Border 3 on.

Oda May

[Facebook page: [facebook.com/ModaBakeShop/](https://www.facebook.com/ModaBakeShop/)]

[Facebook group: [facebook.com/groups/MBSbakers/](https://www.facebook.com/groups/MBSbakers/)]

[Instagram: [@modabakeshop](https://www.instagram.com/modabakeshop/)]

7/15/2018

Original Recipe can be found at www.modabakeshop.com

Recipes are sometimes altered to correct errors. Please ensure that you have downloaded the most recent Printer Friendly Version before starting your project. If you find a mistake in this pattern, please contact modabakeshop@unitednotions.com.

This is an original pattern not intended for sale.

moda BAKE SHOP

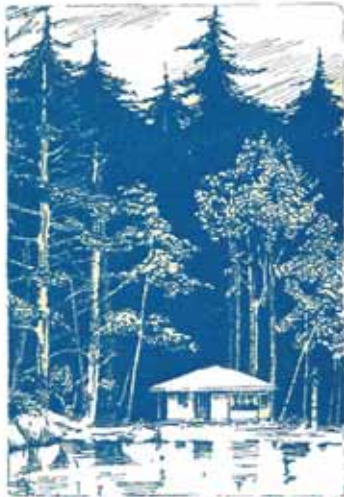

CAMP ODA MAY



EASY

Welcome to the end of Week 4 of the Choose Your Own Adventure Quilt-Along! Today we have the instructions for Border 4.

NOTE: This is one post in a series of quilt-along posts. Start from the beginning with the first post [{here}](#).

We are once again checking in with all our sewers on Instagram, so scroll to the bottom of this post to see how other campers are coming along.

INGREDIENTS

- (2) 2" x 52.5" strips for top/bottom borders
- (2) 2" x 55.5" strips for side borders

NOTE: The fabric requirements were calculated to use background fabric for this border but feel free

to make this border pop with a print! Cut (6) 2" strips of border fabric, remove selvages, sew strips end-to-end, and subcut the long strip into the lengths listed.

INSTRUCTIONS

Lightly starch and press your completed medallion (center block + Round 1 + Round 2 + Round 3). Square it up to 52.5" x 52.5".

Sew 2" x 52.5" strips to the top and bottom of your medallion quilt. Press.

Sew 2" x 55.5" strips to each side of your medallion quilt. Press seams, lightly starch, and then press the whole top one more time.

YIELD

The medallion quilt should measure 55.5" square.

Oda May

[Facebook page: [facebook.com/ModaBakeShop](https://www.facebook.com/ModaBakeShop)]

[Facebook group: [facebook.com/groups/MBSbakers](https://www.facebook.com/groups/MBSbakers)]

[Instagram: [@modabakeshop](https://www.instagram.com/modabakeshop)]

7/22/2018

Original Recipe can be found at www.modabakeshop.com

Recipes are sometimes altered to correct errors. Please ensure that you have downloaded the most recent Printer Friendly Version before starting your project. If you find a mistake in this pattern, please contact modabakeshop@unitednotions.com.

This is an original pattern not intended for sale.

moda BAKE SHOP

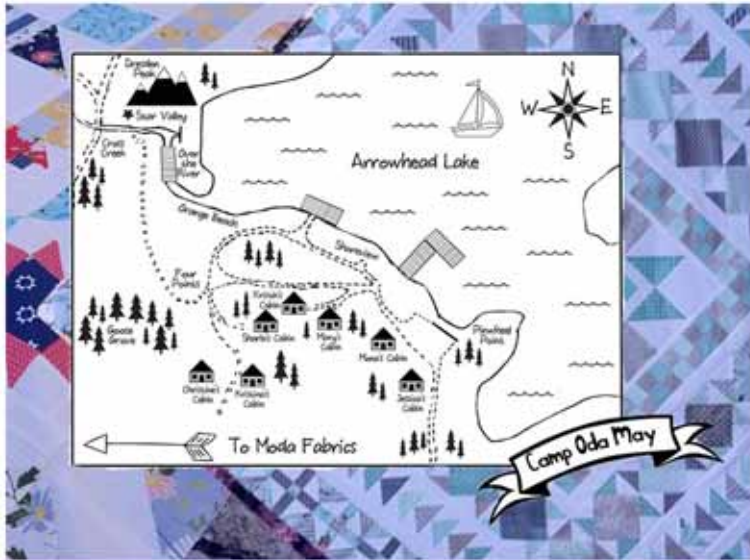

EASY

Here we are at the end of the trail! The Choose Your Own Adventure Quilt-Along is officially wrapping up. Today we have the instructions for Borders 5 and 6.

INGREDIENTS

Border 5 (background fabric)

- (2) 1" x 66" strips for top/bottom borders
- (2) 1" x 67" strips for side borders

Border 6 (border fabric)

- (2) 3.5" x 67" strips for top/bottom borders
- (2) 3.5" x 72" strips for side borders

NOTE: Your border measurements may be slightly different from ours. Read through this Bake Shop Basics post about borders and double check your sizing before you cut: [Bake Shop Basics - Quilt Borders](#).

INSTRUCTIONS

From background fabric, cut (7) 1" x WOF strips. Remove selvages, sew strips end-to-end, and subcut into the lengths listed above for Border 5.

From border fabric, cut (7) 3.5" x WOF strips. Remove selvages, sew strips end-to-end, and subcut into the lengths listed above for Border 6.

Prepare quilt top for borders with a light starch and press.

Border 5 (background fabric)

Sew 1" x 66" strips to the top and bottom of your medallion quilt. Press.

Sew 1" x 67" strips to each side of your medallion quilt. Press.

Border 6 (border fabric)

Sew 3.5" x 67" strips to the top and bottom of your medallion quilt. Press.

Sew 3.5" x 72" strips to each side of your medallion quilt. Press seams, lightly starch, and then press the whole top one more time.

Stay stitch around your entire quilt (sew 1/8" from the outer edge) to keep it in good shape until you get it basted and quilted.

YIELD

The medallion quilt should measure 72" square.

Next Monday (August 6) come back for our Closing Ceremony! We will have some surprises and goodies for you to help you remember our time at Summer Camp.

Oda May

[Facebook page: [facebook.com/ModaBakeShop](https://www.facebook.com/ModaBakeShop)]

[Facebook group: [facebook.com/groups/MBSbakers](https://www.facebook.com/groups/MBSbakers)]

[Instagram: [@modabakeshop](https://www.instagram.com/modabakeshop)]

7/31/2018

Original Recipe can be found at www.modabakeshop.com

Recipes are sometimes altered to correct errors. Please ensure that you have downloaded the most recent Printer Friendly Version before starting your project. If you find a mistake in this pattern, please contact modabakeshop@unitednotions.com.

This is an original pattern not intended for sale.

 **EASY**

Another choice awaits you--will you take the detour over Bow Tie Bridge? These bow tie blocks are the optional cornerstone blocks for this round. Whether to add cornerstone blocks is completely up to you--choose what works best for your quilt!

NOTE: This is one post in a series of quilt-along posts. Start from the beginning with the first post [{here}](#).

Each block requires two fabrics (Fabric A and background) and finishes at 4" square (4.5" unfinished).



INGREDIENTS

Makes four cornerstone blocks

Fabric A:

- [8] 2.5" by 2.5" squares
- [8] 1.5" by 1.5" squares

Background Fabric:

- [8] 2.5" by 2.5" squares

INSTRUCTIONS

Assembling the Block

First, we will create the Easy Corner Triangles (ECTs)

1. Draw a line on the diagonal of the wrong side of (8) 1.5" squares (Fabric A). Place 1.5" square in the bottom left corner of a background square with the diagonal line going from upper left to lower right, as shown.
2. Sew on the line.
3. Trim the corner, leaving a 1/4" seam allowance, as shown.
4. Press unit open (toward Fabric A)

Repeat to create a total of 8 units.

To assemble the block, join the four 2.5" units as shown below.

Repeat to make a total of four cornerstone blocks.

YIELD



The Bow Tie Bridge block finishes at 4" square (measures 4.5" square unfinished).

Kristin Esser

[blog: [Simple. Handmade. Everyday.](#)]

[instagram: [@kristin_esser](#)]

[facebook: [Simple. Handmade. Everyday.](#)]

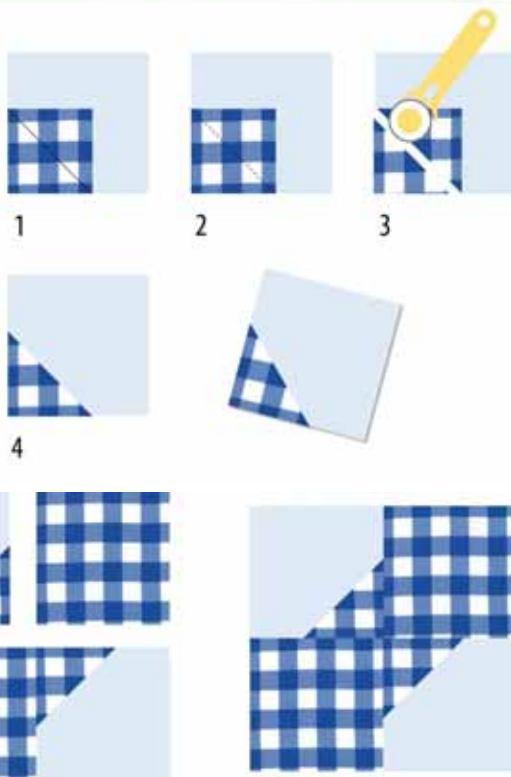

7/19/2018

Original Recipe can be found at www.modabakeshop.com

Recipes are sometimes altered to correct errors. Please ensure that you have downloaded the most recent Printer Friendly Version before starting your project. If you find a mistake in this pattern, please contact modabakeshop@unitednotions.com.

moda BAKE SHOP

EASY

Hi all! This is Camp Counselor Mona Phelps here from Kentucky Whittaker Creations. I hope that you've enjoyed your time at Camp Oda May! The "Choose Your Own Adventure" quilt-along has been so much fun. You can see the wide variety of choices in the Moda Bake Shop



Bakers Facebook group and on Instagram with #chooseyourownadventureqal.

NOTE: This is one post in a series of quilt-along posts. Start from the beginning with the first post [here](#).

Today I am going to share the final cornerstone option for Summer Camp. Mary Andra shared the beautiful Dresden block at Dresden Hollow. This block, a play on a traditional log cabin block, offers a pieced option.

Individual blocks finish at 5" (unfinished 5 1/2").

INGREDIENTS

Makes four cornerstone blocks

- Background fabric: 1.5" x width of fabric.
- Main fabric: 2 Layer cakes or 1 Fat Quarter

Special notes: You may be able to use some of the scraps left from previous blocks. Also, all of my blocks use the same main fabric.

Please feel free to go scrappy with this.

INSTRUCTIONS

Cutting:

From Background fabric, cut:

- (4) 1.5" x 3.5" pieces
- (4) 1.5" x 2.5" pieces

From Main fabric, cut:

- (4) 2.5" x 2.5" pieces
- (4) 2.5" x 3.5" pieces
- (4) 2.5" x 5.5" pieces

Block pieces fit together as shown at right:

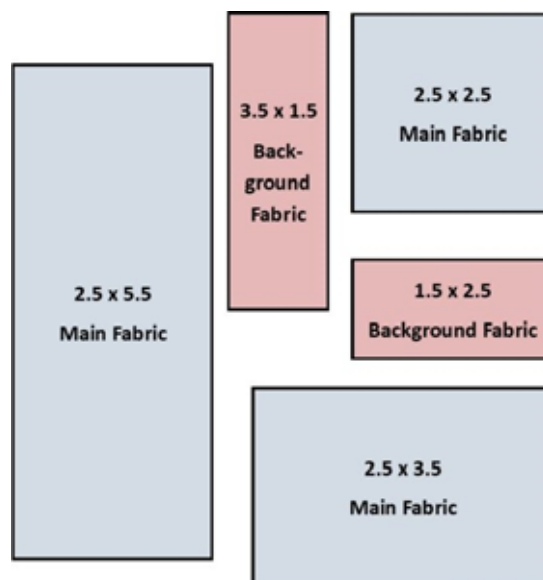

7/30/2018

Original Recipe can be found at www.modabakeshop.com

Recipes are sometimes altered to correct errors. Please ensure that you have downloaded the most recent Printer Friendly Version before starting your project. If you find a mistake in this pattern, please contact modabakeshop@unitednotions.com.

This is an original pattern not intended for sale.

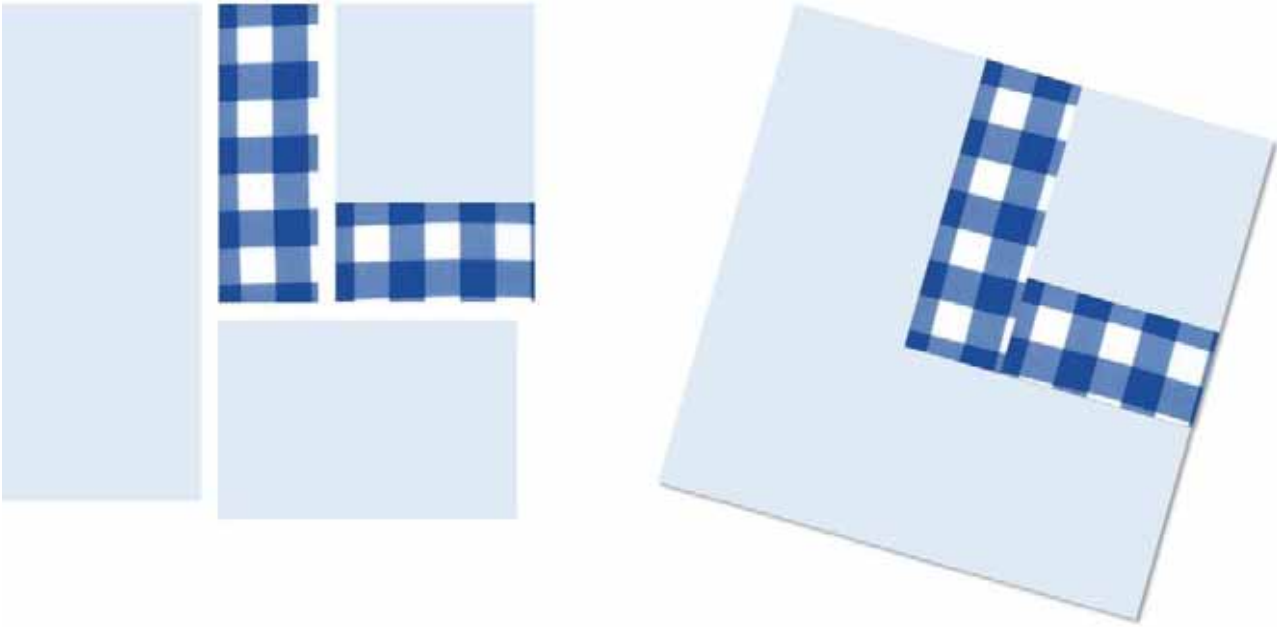

Repeat to make 4 cornerstone blocks.
Here is my finished block:



With this block, you can choose to place your blocks so that the background forms an arrow and points you toward the center.

Or, you can choose to have the cornerstone placed so that the middle section lines up with the Shoreview Blocks.

YIELD

4 blocks. This block finishes at 5" (unfinished 5 1/2")

Thank you for joining me. Later this week we will share the final couple of borders.

Be sure to follow me on Instagram for my most recent updates!

Mona Phelps

[blog: [Kentucky Whittaker Creations](http://KentuckyWhittakerCreations.com)]

[instagram: [@mona.phelps](https://www.instagram.com/mona.phelps)]

[facebook: [facebook.com/ky.whittaker.creations](https://www.facebook.com/ky.whittaker.creations)]

7/30/2018

Original Recipe can be found at www.modabakeshop.com

Recipes are sometimes altered to correct errors. Please ensure that you have downloaded the most recent Printer Friendly Version before starting your project. If you find a mistake in this pattern, please contact modabakeshop@unitednotions.com.

This is an original pattern not intended for sale.

AMBITIOUS

Hello from camp counselor Mary Andra Holmes. Remember back about a month ago when we were on the center medallion? Thinking back I remember asking you to save all those tiny left over pieces as you worked on your Camp Oda May Medallion Quilt. Now is the time to gather all of them together for two appliqued choices for this week's cornerstones!



NOTE: This is one post in a series of quilt-along posts. Start from the beginning with the first post [{here}](#).

Just because I could and I wanted a challenge, I designed a 5" finished, 24 petal Dresden Plate. Have I lost my mind, you may ask? Perhaps, but I absolutely love it.

Just in case this is not for you but you wanted appliqued corners, I designed a 5" finished one quarter 6 petal Dresden Plate. I suggest you turn each one, in the corner square, so they look like they could form a circle.

All the directions are exactly the same as in the center Medallion Dresden Plate block. The only difference is pattern size and you will need (4) 5.5" background fabric blocks. I drew

the patterns pieces as measurements are stated. I did not use a ruler to design these pattern pieces.

Both applique' patterns are attached and printable under the heading "Printer Friendly Version".

PLEASE NOTE: Camp Counselor Mona Whittaker Phelps has an absolutely fabulous pieced BONUS cornerstone block that I know you are going to love, too. The instructions for hers will be available on Monday, July 30.

Block measures 5.5" square unfinished

INGREDIENTS

- (4) 5.5" squares of background fabric
- (24) 2" x 5" scraps for 6-petal Dresden OR (96) 1.5" x 3" scraps for 24-petal Dresden
- (4) 2" x 2" scraps for 6-petal Dresden centers OR (96) 1.5" x 1.5" scraps for 24-petal Dresden centers
- Applique supplies for your preferred method

INSTRUCTIONS

Cutting Instructions:

Please read all instructions before you start this row.

Cut (4) 5.5" squares of background fabric

Use templates to cut applique pieces listed above for desired block from scrap fabric.

Sewing Instructions:

NOTE: a 5.5" block with 1/4" seam allowance is provided for petal placement. Make sure your petal does not fall into the 1/4" seam allowance.

Use the template provided as a placement guide for applique. Using your preferred method, applique the petals to each background square.

Join the cornerstones to the Path A or Path B blocks from this week and this round is done!

YIELD

Each option finishes at 5" square. Make 4.

Mary Andra Holmes

[blog: sistersquiltingtrunk.blogspot.com]

[instagram: [@MAHquilter](https://www.instagram.com/MAHquilter)]

7/27/2018

Original Recipe can be found at www.modabakeshop.com

Recipes are sometimes altered to correct errors. Please ensure that you have downloaded the most recent Printer Friendly Version before starting your project. If you find a mistake in this pattern, please contact modabakeshop@unitednotions.com.

This is an original pattern not intended for sale.

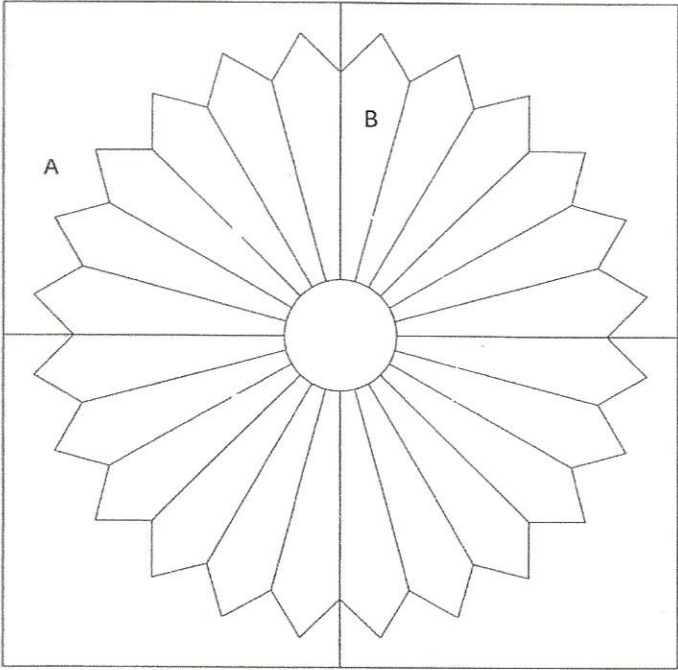

A = 5" finished block

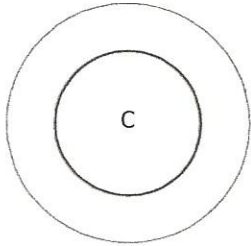

C = 13/16 "

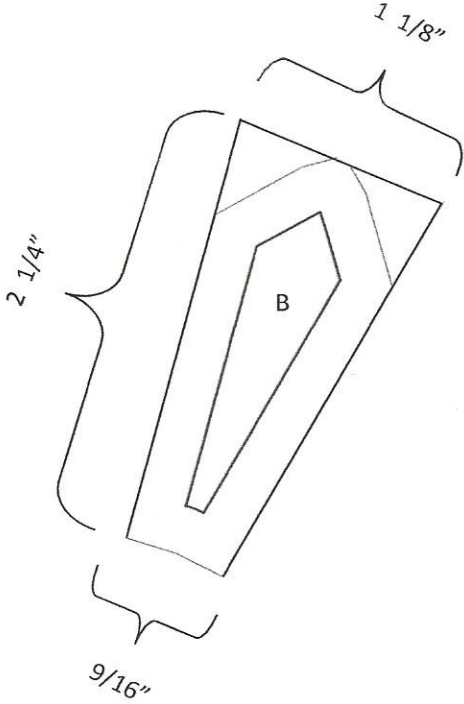

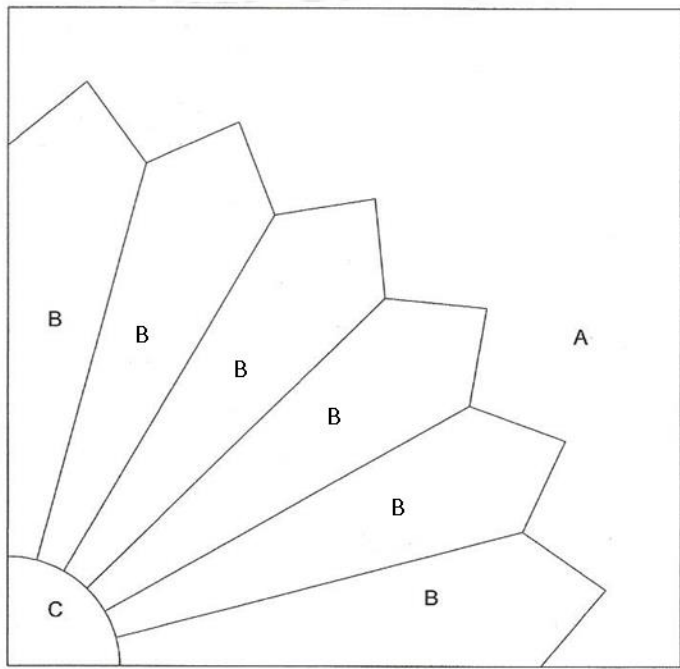

5" finished

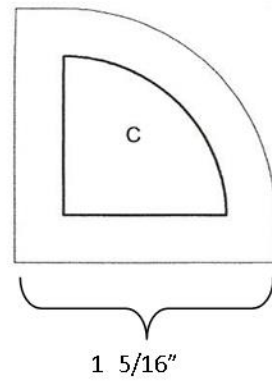
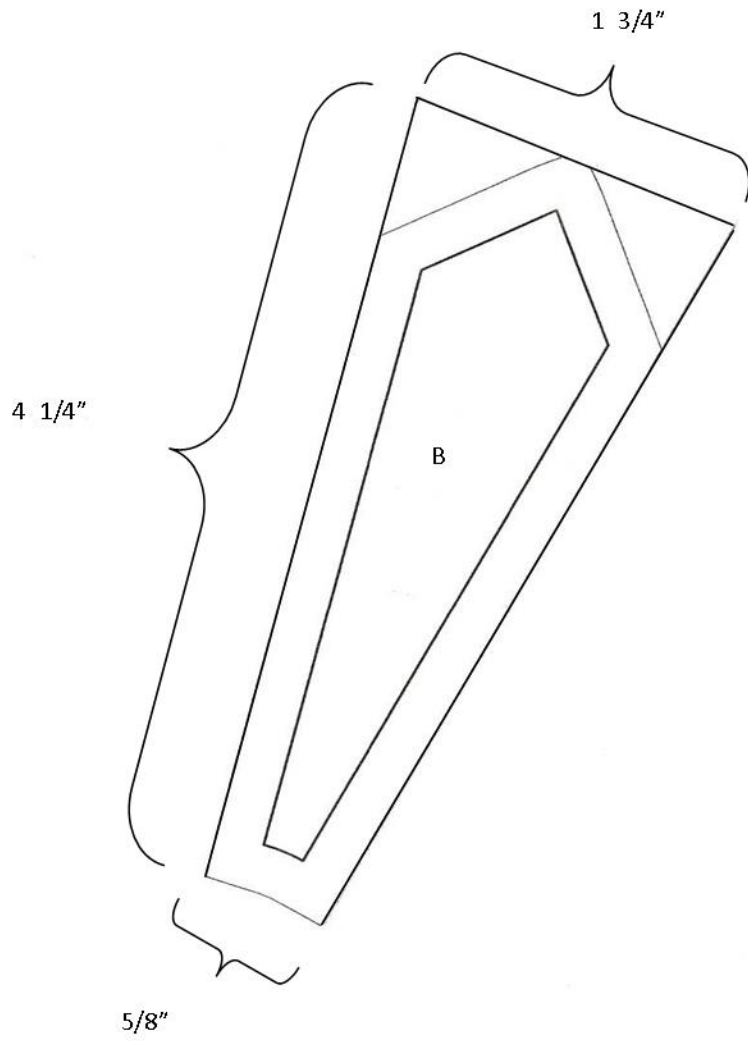

moda BAKE SHOP



EASY

Now that you've seen the two paths for this week at Camp Oda May, we have a cornerstone option for you to add if you'd like! You can choose to eliminate the four corner blocks of Path A (Over the River) or Path B (Pinwheel Point) and put in four copies of this fun and fast Star View block in their place.

NOTE: This is one post in a series of quilt-along posts. Start from the beginning with the first post [{here}](#).

The Star View block finishes at 6" x 6" (6.5" x 6.5" unfinished), so it's easy to mix and match with the other 6" blocks from this week. :)



INGREDIENTS

For four 6" x 6" Star View blocks:

- Background fabric: 5.5" x WOF strip
- Fabric A: 1 FQ or 2 Layer Cake squares
- Fabric B: 1 FQ or 1 Layer Cake squares

The ingredients above can be taken from pieces of layer cake squares and fat quarters that were used in previous portions of your quilt. All of fabric A can be from the same print or make it scrappy and use a bit of several different prints that coordinate with the rest of your quilt. There is no right or wrong way to make these cornerstone blocks!

INSTRUCTIONS

Before beginning:

- Read through the entire instructions
- Seams are all 1/4"
- Width of fabric is abbreviated as WOF and assumed to be 42"

Cutting Instructions

From the background fabric, cut:

- (1) 3.5" x WOF strip, subcut into (16) 3.5" x 2" strips
- (1) 2" x WOF strip, subcut into (16) 2" x 2" squares

7/13/2018

Original Recipe can be found at www.modabakeshop.com

Recipes are sometimes altered to correct errors. Please ensure that you have downloaded the most recent Printer Friendly Version before starting your project. If you find a mistake in this pattern, please contact modabakeshop@unitednotions.com.

This is an original pattern not intended for sale.

From fabric A (the star points), cut:

- (32) 2" x 2" squares

From fabric B (the center of the star), cut:

- (4) 3.5" x 3.5" squares

Assembling the Block:

First, we will assemble the flying geese units.

1. On the wrong side of the (32) 2" x 2" fabric A squares, draw a line diagonally, corner-to-corner.
2. Place one of the 2" fabric A squares right sides together on top of one of the 3.5" x 2" background fabric strips so the side edges line up. Sew a line directly on the drawn line and trim off the excess corner, 1/4" away from the sewn line. Open and press toward the fabric A print (press away from the background fabric).
3. Repeat with another 2" x 2" fabric A square on the other side of the 3.5" x 2" background fabric by sewing on the line and trimming off the excess corner 1/4" away from sewn line.
4. Press the seam toward the fabric A print (away from background fabric) to yield one 3.5" x 2" flying geese unit.

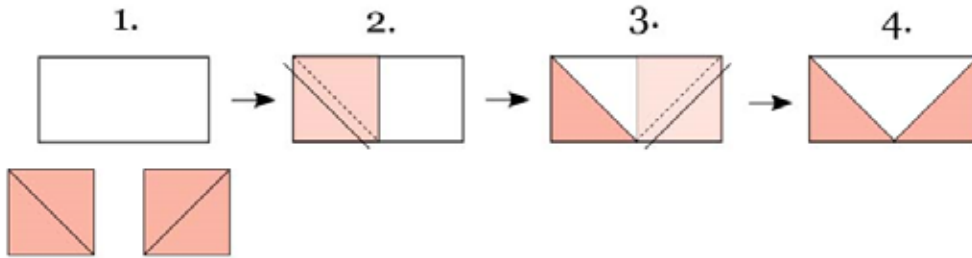

Repeat with the remaining 2" x 2" fabric A squares and 3.5" x 2" background strips to yield (16) total flying geese units. Now we're ready to assemble the Star View blocks.

1. Lay out the flying geese units and the remaining pieces as shown.
2. Assemble the top, middle, and bottom rows. Press seams away from the flying geese units.
3. Sew the three rows together. Press the seams toward the center.

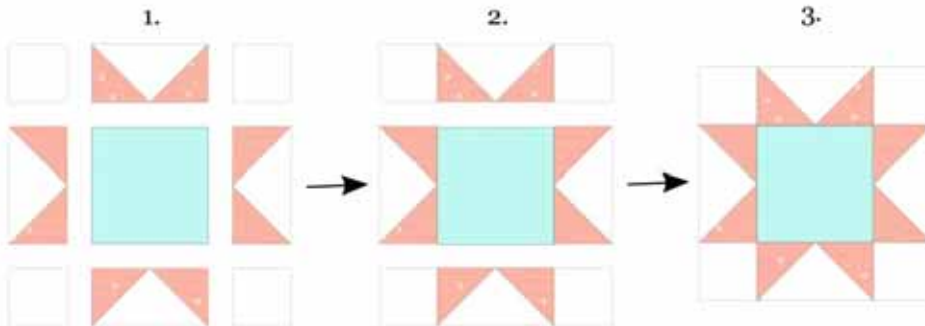

Repeat to yield four star blocks.

YIELD



Your Star View Cornerstone blocks should measure 6 1/2" x 6 1/2" square.

The hike to Star View sure was easy, right?

I have loved seeing everyone's different Camp Oda May quilt along progress! If you post on social media, please use the hashtag #ChooseYourOwnAdventureQAL so we can see your progress! To follow along with my medallion quilt progress, you can check out my instagram account [@centerstreetquilts](#) or Facebook page [HERE](#). Happy sewing!

Kristina Brinkerhoff

www.centerstreetquilts.com

7/13/2018

Original Recipe can be found at www.modabakeshop.com

Recipes are sometimes altered to correct errors. Please ensure that you have downloaded the most recent Printer Friendly Version before starting your project. If you find a mistake in this pattern, please contact modabakeshop@unitednotions.com.

This is an original pattern not intended for sale.

moda BAKE SHOP



EASY

In the hustle and bustle of camp life, it's nice to take a moment to stop and smell the flowers. These tulip blocks are the optional cornerstone blocks for the first round. Whether to add cornerstone blocks is completely up to you--choose what works best for your quilt!

NOTE: This is one post in a series of quilt-along posts. Start from the beginning with the first post [{here}](#).

Each block requires three fabrics (A, B, and background) and finishes at 3 inches square.

INGREDIENTS

makes four cornerstone blocks

Fabric A:

- [4] 3 ½" by 2" rectangles
- [2] 2 ½" squares

Fabric B:

- [4] 1 ¼" square

Background Fabric:

- [4] 1 ¼" square
- [4] 2" by 1 ¼" rectangles
- [4] 2" square
- [2] 2 ½" square

INSTRUCTIONS

Assembling the Block

First, we will assemble the half-square triangles.

7/5/2018

Original Recipe can be found at www.modabakeshop.com

Recipes are sometimes altered to correct errors. Please ensure that you have downloaded the most recent Printer Friendly Version before starting your project. If you find a mistake in this pattern, please contact modabakeshop@unitednotions.com.

This is an original pattern not intended for sale.

HALF-SQUARE TRIANGLES (HSTs)

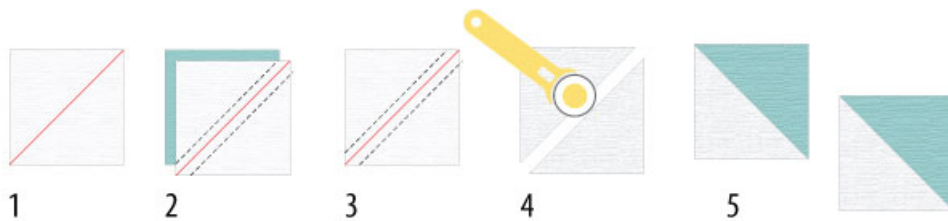

1. Draw a line on the diagonal of the wrong side of (1) 2½" background square.
2. Pair with (1) 2½" square of fabric A.
3. Sew ¼" away from each side of the pencil line.
4. Cut on the pencil line.
5. Press towards the darker fabric and square up to 2".

Next, we will assemble the Easy Corner Triangles (ECTs).

EASY CORNER TRIANGLES (ECTs)

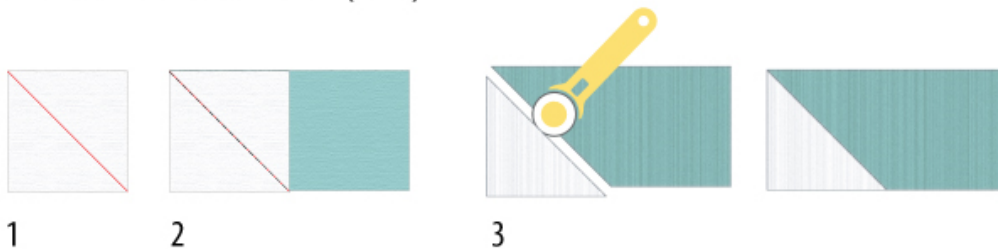

1. Draw a pencil line on the diagonal of (1) 2" square of background fabric.
2. Match the background fabric to the left edge of (1) 3½" by 2" rectangle of fabric A and sew along the pencil line.
3. Trim ¼" to the left of the pencil line and press toward darker fabric.

Finally, we will assemble the block.

Take a 1¼" square of Fabric B and a 1¼" square of background fabric. Sew together. Press towards fabric B. Sew a 2" by 1¼" rectangle of background fabric to the side of the two squares with the square of fabric B in the lower right corner. Press towards the rectangle. Join HST and ECT units as shown below.

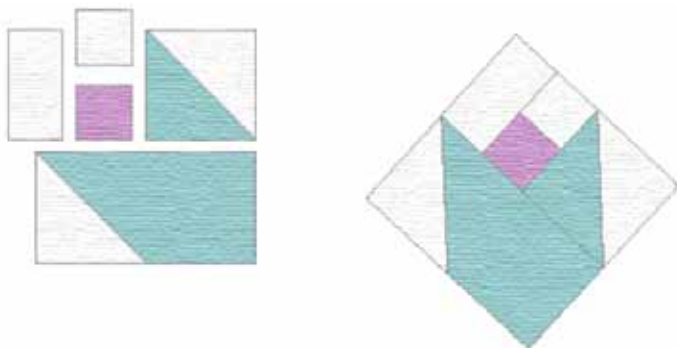

FINISHED BLOCK

Repeat to make a total of four cornerstone blocks.

YIELD

The Tulip Field block finishes at 3" square (measures 3.5" square unfinished).

Christine Weld

[blog: [The Quarter Inch](#)]

[instagram: [@christine.weld](#)]

7/5/2018

Original Recipe can be found at www.modabakeshop.com

Recipes are sometimes altered to correct errors. Please ensure that you have downloaded the most recent Printer Friendly Version before starting your project. If you find a mistake in this pattern, please contact modabakeshop@unitednotions.com.

This is an original pattern not intended for sale.



INGREDIENTS

- 1 Sew-in colorfast fabric sheet for ink jet printer (follow manufacturer's directions for printing)
- Scraps from your prints and background used in your quilt top

INSTRUCTIONS

Cutting Instructions:

- Pine Tree: 3 – 2.5" x 4.5" rectangles
- Pine Tree Background: 6 – 2.5" squares
- Pine Tree Trunk: 1 – 1.5" x 2.5" rectangle
- Pine Tree Trunk Background: 2 – 2" x 2.5" rectangles
- Border A: 2 – 1" x 8.5" rectangles
- Border B: 2 – 1" x 10.5" rectangles

- Border Background: 4 – 1" x 8.5" rectangles
- Border Corner: 4 – 1" squares
- Border Corner Background: 4 – 1" squares



Label Size: 10.5" x 10.5" unfinished (10" x 10" finished)

Sewing Instructions:

Pine Tree (Flying Geese):

Draw a diagonal line from corner to corner on two 2.5" background squares. Layer a background square on the left side of a Pine Tree rectangle, with the drawn line going from the top center of the Pine Tree rectangle to the bottom left corner of the Pine Tree rectangle. Sew on the line. Trim 1/4" from sewn line. Press towards background.

Lay second background square on the right side of the same Pine Tree rectangle, with the drawn line going from the top center of the Pine Tree rectangle to the bottom right corner

of the Pine Tree rectangle. Sew on the line. Trim 1/4" from sewn line. Press towards background. Repeat for a total of 3 Pine Tree sections. Square up flying geese units to measure 2.5" x 4.5".

Sew the 3 Pine Tree sections together along the length of the flying geese, stacked one on top of the other with points facing up. Unit should measure 4.5" x 6.5".

Pine Tree Trunk:

Sew a Pine Tree Trunk Background rectangle on either side of the Pine Tree Trunk along the 2.5" lengths. Press seams towards trunk. Unit should measure 2.5" x 4.5".

Sew the trunk unit to the bottom of the Pine Tree Unit. Press seams towards trunk unit. Pine Tree should measure 4.5" x 8.5".

Label Center:

Sew the Pine Tree Unit to the left side of the 4.5" x 8.5" printed label. Press seam towards label. Center should measure 8.5" x 8.5".

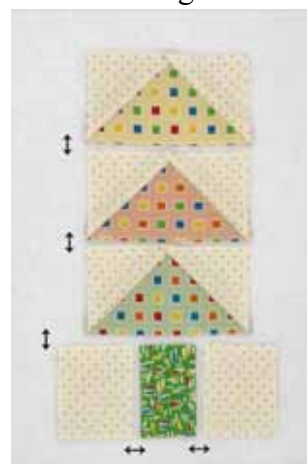

8/6/2018

Original Recipe can be found at www.modabakeshop.com

Recipes are sometimes altered to correct errors. Please ensure that you have downloaded the most recent Printer Friendly Version before starting your project. If you find a mistake in this pattern, please contact modabakeshop@unitednotions.com.

This is an original pattern not intended for sale.

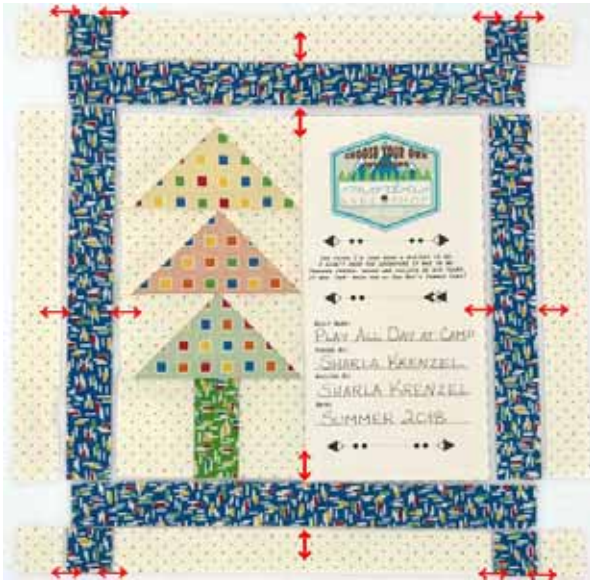

Border:

Sew a Border A rectangle to a Border Background rectangle along the length of rectangles. Press seam to dark fabric. Repeat for a total of 2 border units. Border unit should measure 1.5" x 8.5". Sew one border unit to the right and one to left of the center label with the Border A fabric (not background) next to the label.

Sew a Border Corner square to a Border Corner Background square. Press towards darker fabric. Repeat to make a total 4 units. Unit should measure 1" x 1.5".

Sew a Border Corner unit on each end of a Border Background rectangle, with the Border Corner fabric (not background) next to the Border Background rectangle. Repeat to make 2 units. Unit should measure 1" x 10.5".

Sew a Border Corner/Background unit to a Border B rectangle along the length. Press towards the Border B fabric. Repeat for a

total of 2 units. Sew one unit to the top and bottom of the label center with the Border B fabric next to the label. Press towards border.

Attaching the Label:

Press the four edges of the label block under $\frac{1}{4}$ ". Hand stitch the block to the back of your finished quilt. You could also piece this block into your backing if desired.

YIELD

Label block should measure 10.5" x 10.5" unfinished.

Sharla Krenzel

blog: [Thistle Thicket Studio](http://ThistleThicketStudio.com)

instagram: [@thistlethicketstudio](https://www.instagram.com/thistlethicketstudio)

Choose Your Own Adventure QAL Quilt Label



This square should measure 1" when printed.

The label, at right, should measure 4.5" x 8.5" when printed.

Cut label on dotted line.

Use waterproof permanent marking pen to fill out information. Heat set ink with iron.

Sew label into pieced label block or use label only. Sew onto back of quilt.

Pieced Pine Tree block label measures 10.5" x 10.5" unfinished (10" x 10" finished).



*THE PATHS I'D TAKE WERE A MYSTERY TO ME,
I DIDN'T KNOW THE ADVENTURE IT WAS TO BE.
THROUGH CREEKS, WOODS AND VALLEYS WE DID TRAMP,
IT WAS 'SEW' MUCH FUN AT ODA MAY'S SUMMER CAMP!*



QUILT NAME:

PIECED BY:

QUILTED BY:

DATE:

